

HIGHLIGHTS OF PRESCRIBING INFORMATION

These highlights do not include all the information needed to use OPUVIZ safely and effectively. See full prescribing information for OPUVIZ.

OPUVIZ™ (aflibercept-yszy) injection, for intravitreal use

Initial U.S. Approval: 2024

OPUVIZ (aflibercept-yszy) is biosimilar* to EYLEA (aflibercept)

INDICATIONS AND USAGE

OPUVIZ is a vascular endothelial growth factor (VEGF) inhibitor indicated for the treatment of patients with:

- Neovascular (Wet) Age-Related Macular Degeneration (AMD) (1.1)
- Macular Edema Following Retinal Vein Occlusion (RVO) (1.2)
- Diabetic Macular Edema (DME) (1.3)
- Diabetic Retinopathy (DR) (1.4)

DOSAGE AND ADMINISTRATION

- **Neovascular (Wet) Age-Related Macular Degeneration (AMD)**
 - The recommended dose for OPUVIZ is 2 mg (0.05 mL of 40 mg/mL solution) administered by intravitreal injection every 4 weeks (approximately every 28 days, monthly) for the first 3 months, followed by 2 mg (0.05 mL of 40 mg/mL solution) via intravitreal injection once every 8 weeks (2 months). (2.2)
 - Although OPUVIZ may be dosed as frequently as 2 mg every 4 weeks (approximately every 25 days, monthly), additional efficacy was not demonstrated in most patients when aflibercept was dosed every 4 weeks compared to every 8 weeks. Some patients may need every 4 week (monthly) dosing after the first 12 weeks (3 months). (2.2)
 - Although not as effective as the recommended every 8 week dosing regimen, patients may also be treated with one dose every 12 weeks after one year of effective therapy. Patients should be assessed regularly. (2.2)
- **Macular Edema Following Retinal Vein Occlusion (RVO)**
 - The recommended dose for OPUVIZ is 2 mg (0.05 mL of 40 mg/mL solution) administered by intravitreal injection once every 4 weeks (approximately every 25 days, monthly). (2.3)
- **Diabetic Macular Edema (DME) and Diabetic Retinopathy (DR)**
 - The recommended dose for OPUVIZ is 2 mg (0.05 mL of 40 mg/mL solution) administered by intravitreal injection every 4 weeks (approximately every 28 days, monthly) for the first 5 injections followed by 2 mg (0.05 mL of 40 mg/mL solution) via intravitreal injection once every 8 weeks (2 months). (2.4, 2.5)

- Although OPUVIZ may be dosed as frequently as 2 mg every 4 weeks (approximately every 25 days, monthly), additional efficacy was not demonstrated in most patients when aflibercept was dosed every 4 weeks compared to every 8 weeks. Some patients may need every 4 week (monthly) dosing after the first 20 weeks (5 months). (2.4, 2.5)

DOSAGE FORMS AND STRENGTHS

Injection: 2 mg (0.05 mL of 40 mg/mL) solution in a single-dose vial (3)

CONTRAINDICATIONS

- Ocular or periocular infections (4.1)
- Active intraocular inflammation (4.2)
- Hypersensitivity (4.3)

WARNINGS AND PRECAUTIONS

- Endophthalmitis, retinal detachments, and retinal vasculitis with or without occlusion may occur following intravitreal injections. Patients and/or caregivers should be instructed to report any signs and/or symptoms suggestive of endophthalmitis, retinal detachment, or retinal vasculitis without delay and should be managed appropriately. (5.1)
- Increases in intraocular pressure have been seen within 60 minutes of an intravitreal injection. (5.2)
- There is a potential risk of arterial thromboembolic events following intravitreal use of VEGF inhibitors. (5.3)

ADVERSE REACTIONS

The most common adverse reactions (≥5%) reported in patients receiving aflibercept were conjunctival hemorrhage, eye pain, cataract, vitreous detachment, vitreous floaters, and intraocular pressure increased. (6.1)

To report SUSPECTED ADVERSE REACTIONS, contact Biogen MA Inc. at 1-866-MED-INFO (1-866-633-4636) or FDA at 1-800-FDA-1088 or www.fda.gov/medwatch.

See 17 for PATIENT COUNSELING INFORMATION

*Biosimilar means that the biological product is approved based on data demonstrating that it is highly similar to an FDA-approved biological product, known as a reference product, and that there are no clinically meaningful differences between the biosimilar product and the reference product. Biosimilarity of OPUVIZ has been demonstrated for the condition(s) of use (e.g., indication(s), dosing regimen(s)), strength(s), dosage form(s), and route(s) of administration described in its Full Prescribing Information.

Revised: 5/2024

FULL PRESCRIBING INFORMATION: CONTENTS*

1 INDICATIONS AND USAGE

- 1.1 Neovascular (Wet) Age-Related Macular Degeneration (AMD)
- 1.2 Macular Edema Following Retinal Vein Occlusion (RVO)
- 1.3 Diabetic Macular Edema (DME)
- 1.4 Diabetic Retinopathy (DR)

2 DOSAGE AND ADMINISTRATION

- 2.1 Important Injection Instructions
- 2.2 Neovascular (Wet) Age-Related Macular Degeneration (AMD)
- 2.3 Macular Edema Following Retinal Vein Occlusion (RVO)
- 2.4 Diabetic Macular Edema (DME)
- 2.5 Diabetic Retinopathy (DR)
- 2.6 Preparation for Administration - Vial
- 2.7 Injection Procedure

3 DOSAGE FORMS AND STRENGTHS

4 CONTRAINDICATIONS

- 4.1 Ocular or Periocular Infections
- 4.2 Active Intraocular Inflammation
- 4.3 Hypersensitivity

5 WARNINGS AND PRECAUTIONS

- 5.1 Endophthalmitis, Retinal Detachments, and Retinal Vasculitis with or without Occlusion
- 5.2 Increase in Intraocular Pressure
- 5.3 Thromboembolic Events

6 ADVERSE REACTIONS

- 6.1 Clinical Trials Experience
- 6.2 Postmarketing Experience

8 USE IN SPECIFIC POPULATIONS

8.1 Pregnancy

8.2 Lactation

8.3 Females and Males of Reproductive Potential

8.4 Pediatric Use

8.5 Geriatric Use

10 OVERDOSAGE

11 DESCRIPTION

12 CLINICAL PHARMACOLOGY

12.1 Mechanism of Action

12.2 Pharmacodynamics

12.3 Pharmacokinetics

12.6 Immunogenicity

13 NONCLINICAL TOXICOLOGY

13.1 Carcinogenesis, Mutagenesis, Impairment of Fertility

13.2 Animal Toxicology and/or Pharmacology

14 CLINICAL STUDIES

14.1 Neovascular (Wet) Age-Related Macular Degeneration (AMD)

14.2 Macular Edema Following Central Retinal Vein Occlusion (CRVO)

14.3 Macular Edema Following Branch Retinal Vein Occlusion (BRVO)

14.4 Diabetic Macular Edema (DME)

14.5 Diabetic Retinopathy (DR)

16 HOW SUPPLIED/STORAGE AND HANDLING

16.1 How Supplied

16.2 Storage and Handling

17 PATIENT COUNSELING INFORMATION

* Sections or subsections omitted from the full prescribing information are not listed.

FULL PRESCRIBING INFORMATION

1 INDICATIONS AND USAGE

OPUVIZ is indicated for the treatment of:

1.1 Neovascular (Wet) Age-Related Macular Degeneration (AMD)

1.2 Macular Edema Following Retinal Vein Occlusion (RVO)

1.3 Diabetic Macular Edema (DME)

1.4 Diabetic Retinopathy (DR)

2 DOSAGE AND ADMINISTRATION

2.1 Important Injection Instructions

For ophthalmic intravitreal injection. OPUVIZ must only be administered by a qualified physician.

Vial: A 5-micron sterile filter needle (18-gauge × 1½-inch), a 1-mL Luer lock syringe and a 30-gauge × ½-inch sterile injection needle are needed.

OPUVIZ is available packaged as follows:

- Vial Kit with Injection Components (filter needle, syringe, injection needle)
- Vial Only [see [How Supplied/Storage and Handling \(16\)](#)].

2.2 Neovascular (Wet) Age-Related Macular Degeneration (AMD)

The recommended dose for OPUVIZ is 2 mg (0.05 mL of 40 mg/mL solution) administered by intravitreal injection every 4 weeks (approximately every 28 days, monthly) for the first 12 weeks (3 months), followed by 2 mg (0.05 mL of 40 mg/mL solution) via intravitreal injection once every 8 weeks (2 months). Although OPUVIZ may be dosed as frequently as 2 mg every 4 weeks (approximately every 25 days, monthly), additional efficacy was not demonstrated in most patients when aflibercept was dosed every 4 weeks compared to every 8 weeks [see [Clinical Studies \(14.1\)](#)]. Some patients may need every 4 week (monthly) dosing after the first 12 weeks (3 months). Although not as effective as the recommended every 8 week dosing regimen, patients may also be treated with one dose every 12 weeks after one year of effective therapy. Patients should be assessed regularly.

2.3 Macular Edema Following Retinal Vein Occlusion (RVO)

The recommended dose for OPUVIZ is 2 mg (0.05 mL of 40 mg/mL solution) administered by intravitreal injection once every 4 weeks (approximately every 25 days, monthly) [see [Clinical Studies \(14.2\)](#), [\(14.3\)](#)].

2.4 Diabetic Macular Edema (DME)

The recommended dose for OPUVIZ is 2 mg (0.05 mL of 40 mg/mL solution) administered by intravitreal injection every 4 weeks (approximately every 28 days, monthly) for the first 5 injections, followed by 2 mg (0.05 mL of 40 mg/mL solution) via intravitreal injection once every 8 weeks (2 months). Although OPUVIZ may be dosed as frequently as 2 mg every 4 weeks (approximately every 25 days, monthly), additional efficacy was not demonstrated in most patients when aflibercept was dosed every 4 weeks compared to every 8 weeks [see [Clinical Studies \(14.4\)](#)]. Some patients may need every 4 week (monthly) dosing after the first 20 weeks (5 months).

2.5 Diabetic Retinopathy (DR)

The recommended dose for OPUVIZ is 2 mg (0.05 mL of 40 mg/mL solution) administered by intravitreal injection every 4 weeks (approximately every 28 days, monthly) for the first 5 injections, followed by 2 mg (0.05 mL of 40 mg/mL solution) via intravitreal injection once every 8 weeks (2 months). Although OPUVIZ may be dosed as frequently as 2 mg every 4 weeks (approximately every 25 days, monthly), additional efficacy was not demonstrated in most patients when aflibercept was dosed every 4 weeks compared to every 8 weeks [see *Clinical Studies (14.5)*]. Some patients may need every 4 week (monthly) dosing after the first 20 weeks (5 months).

2.6 Preparation for Administration - Vial

OPUVIZ should be inspected visually prior to administration. If particulates, cloudiness, or discoloration are visible, the vial must not be used.

The glass vial is for one-time use in one eye only. Discard unused portion.

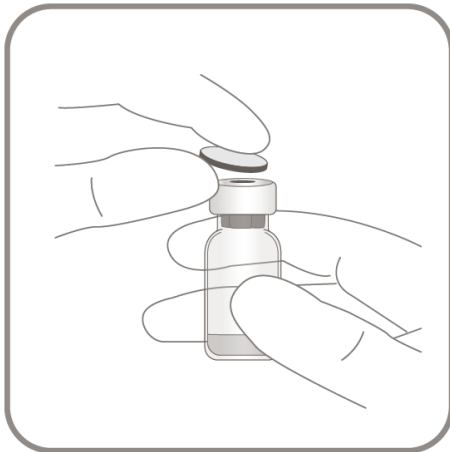
Use aseptic technique to carry out the following preparation steps:

Prepare for intravitreal injection with the following medical devices for single use:

- a 5-micron sterile filter needle (18-gauge × 1½-inch)
- a 1-mL sterile Luer lock syringe (with marking to measure 0.05 mL)
- a sterile injection needle (30-gauge × ½-inch)

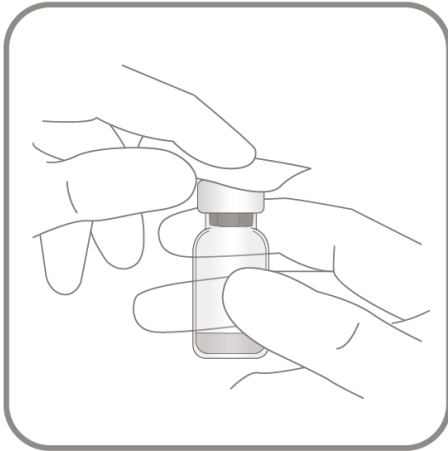
1. Remove the protective plastic cap from the vial (see [Figure 1](#)).

Figure 1



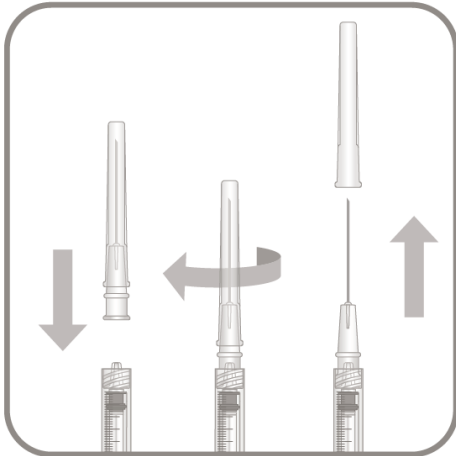
2. Clean the top of the vial with an alcohol wipe (see [Figure 2](#)).

Figure 2



3. Remove the 18-gauge \times 1½-inch, 5-micron, filter needle and the 1-mL syringe from their packaging. Attach the filter needle to the syringe by twisting it onto the Luer lock syringe tip (see [Figure 3](#)).

Figure 3



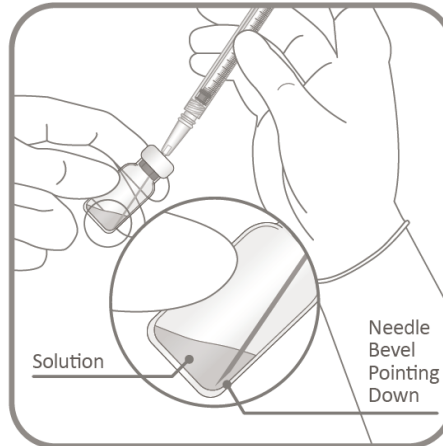
4. Push the filter needle into the center of the vial stopper until the needle is completely inserted into the vial and the tip touches the bottom or bottom edge of the vial.

- Using aseptic technique withdraw all of the OPUVIZ vial contents into the syringe, keeping the vial in an upright position, slightly inclined to ease complete withdrawal. To deter the introduction of air, ensure the bevel of the filter needle is submerged into the liquid. Continue to tilt the vial during withdrawal keeping the bevel of the filter needle submerged in the liquid (see [Figure 4a](#) and [Figure 4b](#)).

Figure 4a

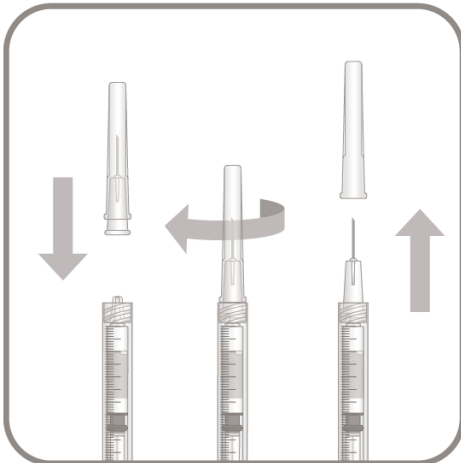


Figure 4b



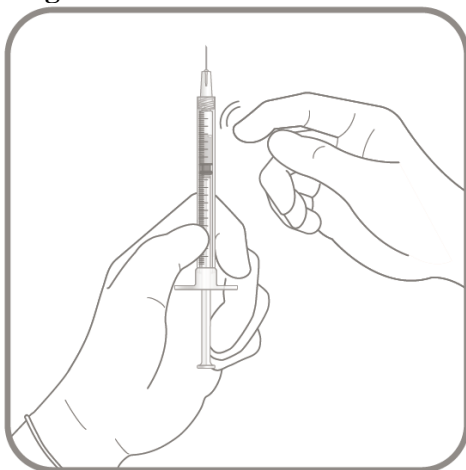
- Ensure that the plunger rod is drawn sufficiently back when emptying the vial in order to completely empty the filter needle.
- Remove the filter needle from the syringe and properly dispose of the filter needle.
Note: Filter needle is **not** to be used for intravitreal injection.
- Remove the 30-gauge \times $\frac{1}{2}$ -inch injection needle from its packaging and attach the injection needle to the syringe by firmly twisting the injection needle onto the Luer lock syringe tip (see [Figure 5](#)).
- When ready to administer OPUVIZ, remove the plastic needle cap from the needle (see [Figure 5](#)).

Figure 5



10. Holding the syringe with the needle pointing up, check the syringe for bubbles. If there are bubbles, gently tap the syringe with your finger until the bubbles rise to the top (see [Figure 6](#)).

Figure 6



11. To eliminate all of the bubbles and to expel excess drug, SLOWLY depress the plunger rod so that the plunger edge aligns with the line that marks 0.05 mL on the syringe (see [Figure 7a](#) and [Figure 7b](#)).

Figure 7a

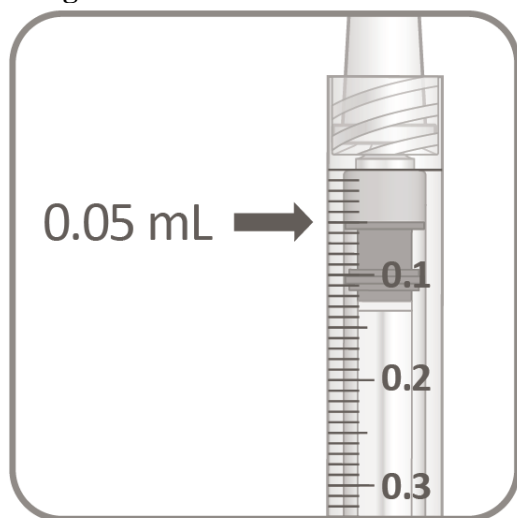
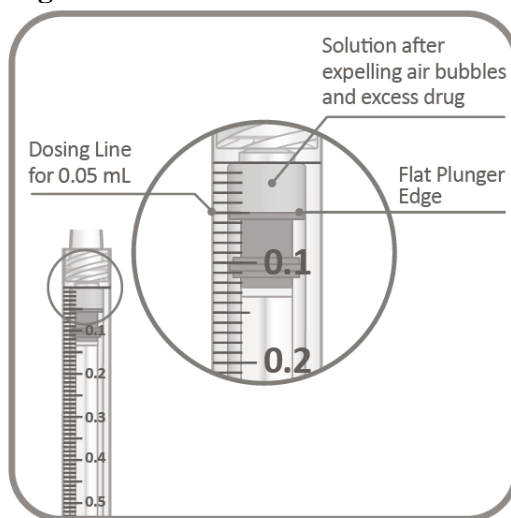


Figure 7b



2.7 Injection Procedure

The intravitreal injection procedure should be carried out under controlled aseptic conditions, which include surgical hand disinfection and the use of sterile gloves, a sterile drape, and a sterile eyelid speculum (or equivalent). Adequate anesthesia and a topical broad-spectrum microbicide should be given prior to the injection.

Immediately following the intravitreal injection, patients should be monitored for elevation in intraocular pressure. Appropriate monitoring may consist of a check for perfusion of the optic nerve head or tonometry. If required, a sterile paracentesis needle should be available.

Following intravitreal injection, patients and/or caregivers should be instructed to report any signs and/or

symptoms suggestive of endophthalmitis or retinal detachment (e.g., eye pain, redness of the eye, photophobia, blurring of vision) without delay [see *Patient Counseling Information (17)*].

Each sterile vial should only be used for the treatment of a single eye. If the contralateral eye requires treatment, a new sterile vial should be used and the sterile field, syringe, gloves, drapes, eyelid speculum, filter, and injection needles should be changed before OPUVIZ is administered to the other eye.

After injection, any unused product must be discarded.

3 DOSAGE FORMS AND STRENGTHS

OPUVIZ is a clear, colorless to pale yellow solution available as:

- Injection: 2 mg (0.05 mL of a 40 mg/mL solution) in a single-dose glass vial

4 CONTRAINDICATIONS

4.1 Ocular or Periocular Infections

OPUVIZ is contraindicated in patients with ocular or periocular infections.

4.2 Active Intraocular Inflammation

OPUVIZ is contraindicated in patients with active intraocular inflammation.

4.3 Hypersensitivity

OPUVIZ is contraindicated in patients with known hypersensitivity to aflibercept or any of the excipients in OPUVIZ. Hypersensitivity reactions may manifest as rash, pruritus, urticaria, severe anaphylactic/anaphylactoid reactions, or severe intraocular inflammation.

5 WARNINGS AND PRECAUTIONS

5.1 Endophthalmitis, Retinal Detachments, and Retinal Vasculitis with or without Occlusion

Intravitreal injections, including those with aflibercept products, have been associated with endophthalmitis and retinal detachments [see *Adverse Reactions (6.1)*] and, more rarely, retinal vasculitis with or without occlusion [see *Adverse Reactions (6.2)*]. Proper aseptic injection technique must always be used when administering OPUVIZ. Patients and/or caregivers should be instructed to report any signs and/or symptoms suggestive of endophthalmitis, retinal detachment, or retinal vasculitis without delay and should be managed appropriately [see *Dosage and Administration (2.7)* and *Patient Counseling Information (17)*].

5.2 Increase in Intraocular Pressure

Acute increases in intraocular pressure have been seen within 60 minutes of intravitreal injection, including with aflibercept products [see *Adverse Reactions (6.1)*]. Sustained increases in intraocular pressure have also been reported after repeated intravitreal dosing with vascular endothelial growth factor (VEGF) inhibitors. Intraocular pressure and the perfusion of the optic nerve head should be monitored and managed appropriately [see *Dosage and Administration (2.7)*].

5.3 Thromboembolic Events

There is a potential risk of arterial thromboembolic events (ATEs) following intravitreal use of VEGF inhibitors, including aflibercept products. ATEs are defined as nonfatal stroke, nonfatal myocardial infarction,

or vascular death (including deaths of unknown cause). The incidence of reported thromboembolic events in wet AMD studies during the first year was 1.8% (32 out of 1824) in the combined group of patients treated with aflibercept compared with 1.5% (9 out of 595) in patients treated with ranibizumab; through 96 weeks, the incidence was 3.3% (60 out of 1824) in the aflibercept group compared with 3.2% (19 out of 595) in the ranibizumab group. The incidence in the DME studies from baseline to week 52 was 3.3% (19 out of 578) in the combined group of patients treated with aflibercept compared with 2.8% (8 out of 287) in the control group; from baseline to week 100, the incidence was 6.4% (37 out of 578) in the combined group of patients treated with aflibercept compared with 4.2% (12 out of 287) in the control group. There were no reported thromboembolic events in the patients treated with aflibercept in the first six months of the RVO studies.

6 ADVERSE REACTIONS

The following potentially serious adverse reactions are described elsewhere in the labeling:

- Hypersensitivity [*see Contraindications (4.3)*]
- Endophthalmitis, Retinal detachments, and Retinal Vasculitis with or without Occlusion [*see Warnings and Precautions (5.1)*]
- Increase in intraocular pressure [*see Warnings and Precautions (5.2)*]
- Thromboembolic events [*see Warnings and Precautions (5.3)*]

6.1 Clinical Trials Experience

Because clinical trials are conducted under widely varying conditions, adverse reaction rates observed in the clinical trials of a drug cannot be directly compared to rates in other clinical trials of the same or another drug and may not reflect the rates observed in practice.

A total of 2980 adult patients treated with aflibercept constituted the safety population in eight phase 3 studies. Among those, 2379 patients were treated with the recommended dose of 2 mg. Serious adverse reactions related to the injection procedure have occurred in <0.1% of intravitreal injections with aflibercept including endophthalmitis and retinal detachment. The most common adverse reactions ($\geq 5\%$) reported in patients receiving aflibercept were conjunctival hemorrhage, eye pain, cataract, vitreous detachment, vitreous floaters, and intraocular pressure increased.

Neovascular (Wet) Age-Related Macular Degeneration (AMD)

The data described below reflect exposure to aflibercept in 1824 patients with wet AMD, including 1223 patients treated with the 2-mg dose, in 2 double-masked, controlled clinical studies (VIEW1 and VIEW2) for 24 months (with active control in year 1) [*see Clinical Studies (14.1)*].

Safety data observed in the aflibercept group in a 52-week, double-masked, Phase 2 study were consistent with these results.

Table 1: Most Common Adverse Reactions (≥1%) in Wet AMD Studies

Adverse Reactions	Baseline to Week 52		Baseline to Week 96	
	Aflibercept (N=1824)	Active Control (ranibizumab) (N=595)	Aflibercept (N=1824)	Control (ranibizumab) (N=595)
Conjunctival hemorrhage	25%	28%	27%	30%
Eye pain	9%	9%	10%	10%
Cataract	7%	7%	13%	10%
Vitreous detachment	6%	6%	8%	8%
Vitreous floaters	6%	7%	8%	10%
Intraocular pressure increased	5%	7%	7%	11%
Ocular hyperemia	4%	8%	5%	10%
Corneal epithelium defect	4%	5%	5%	6%
Detachment of the retinal pigment epithelium	3%	3%	5%	5%
Injection site pain	3%	3%	3%	4%
Foreign body sensation in eyes	3%	4%	4%	4%
Lacrimation increased	3%	1%	4%	2%
Vision blurred	2%	2%	4%	3%
Intraocular inflammation	2%	3%	3%	4%
Retinal pigment epithelium tear	2%	1%	2%	2%
Injection site hemorrhage	1%	2%	2%	2%
Eyelid edema	1%	2%	2%	3%
Corneal edema	1%	1%	1%	1%
Retinal detachment	<1%	<1%	1%	1%

Less common serious adverse reactions reported in <1% of the patients treated with aflibercept were hypersensitivity, retinal tear, and endophthalmitis.

Macular Edema Following Retinal Vein Occlusion (RVO)

The data described below reflect 6 months exposure to aflibercept with a monthly 2 mg dose in 218 patients following central retinal vein occlusion (CRVO) in 2 clinical studies (COPERNICUS and GALILEO) and 91 patients following branch retinal vein occlusion (BRVO) in one clinical study (VIBRANT) [see *Clinical Studies (14.2), (14.3)*].

Table 2: Most Common Adverse Reactions (≥1%) in RVO Studies

Adverse Reactions	CRVO		BRVO	
	Aflibercept (N=218)	Control (N=142)	Aflibercept (N=91)	Control (N=92)
Eye pain	13%	5%	4%	5%
Conjunctival hemorrhage	12%	11%	20%	4%
Intraocular pressure increased	8%	6%	2%	0%
Corneal epithelium defect	5%	4%	2%	0%
Vitreous floaters	5%	1%	1%	0%
Ocular hyperemia	5%	3%	2%	2%
Foreign body sensation in eyes	3%	5%	3%	0%
Vitreous detachment	3%	4%	2%	0%
Lacrimation increased	3%	4%	3%	0%
Injection site pain	3%	1%	1%	0%
Vision blurred	1%	<1%	1%	1%
Intraocular inflammation	1%	1%	0%	0%
Cataract	<1%	1%	5%	0%
Eyelid edema	<1%	1%	1%	0%

Less common adverse reactions reported in <1% of the patients treated with aflibercept in the CRVO studies were corneal edema, retinal tear, hypersensitivity, and endophthalmitis.

Diabetic Macular Edema (DME) and Diabetic Retinopathy (DR)

The data described below reflect exposure to aflibercept in 578 patients with DME treated with the 2-mg dose in 2 double-masked, controlled clinical studies (VIVID and VISTA) from baseline to week 52 and from baseline to week 100 [see *Clinical Studies (14.4)*].

Table 3: Most Common Adverse Reactions (≥1%) in DME Studies

Adverse Reactions	Baseline to Week 52		Baseline to Week 100	
	Aflibercept (N=578)	Control (N=287)	Aflibercept (N=578)	Control (N=287)
Conjunctival hemorrhage	28%	17%	31%	21%
Eye pain	9%	6%	11%	9%
Cataract	8%	9%	19%	17%
Vitreous floaters	6%	3%	8%	6%
Corneal epithelium defect	5%	3%	7%	5%
Intraocular pressure increased	5%	3%	9%	5%
Ocular hyperemia	5%	6%	5%	6%
Vitreous detachment	3%	3%	8%	6%
Foreign body sensation in eyes	3%	3%	3%	3%
Lacrimation increased	3%	2%	4%	2%
Vision blurred	2%	2%	3%	4%
Intraocular inflammation	2%	<1%	3%	1%
Injection site pain	2%	<1%	2%	<1%
Eyelid edema	<1%	1%	2%	1%

Less common adverse reactions reported in <1% of the patients treated with aflibercept were hypersensitivity, retinal detachment, retinal tear, corneal edema, and injection site hemorrhage.

Safety data observed in 269 patients with nonproliferative diabetic retinopathy (NPDR) through week 52 in the PANORAMA trial were consistent with those seen in the phase 3 VIVID and VISTA trials (see [Table 3](#) above).

6.2 Postmarketing Experience

The following adverse reactions have been identified during postapproval use of aflibercept. Because these reactions are reported voluntarily from a population of uncertain size, it is not always possible to reliably estimate their frequency or establish a causal relationship to drug exposure.

Eye disorders: retinal vasculitis and occlusive retinal vasculitis related to intravitreal injection with aflibercept (reported at a rate of 0.6 and 0.2 per 1 million injections, respectively, based on postmarketing experience from November 2011 until November 2023).

8 USE IN SPECIFIC POPULATIONS

8.1 Pregnancy

Risk Summary

Adequate and well-controlled studies with aflibercept have not been conducted in pregnant women. Aflibercept produced adverse embryofetal effects in rabbits, including external, visceral, and skeletal malformations. A fetal No Observed Adverse Effect Level (NOAEL) was not identified. At the lowest dose shown to produce adverse embryofetal effects, systemic exposures (based on AUC for free aflibercept) were approximately 6 times higher than AUC values observed in humans after a single intravitreal treatment at the recommended clinical dose (*see Data*).

Animal reproduction studies are not always predictive of human response, and it is not known whether aflibercept can cause fetal harm when administered to a pregnant woman. Based on the anti-VEGF mechanism of action for aflibercept [*see Clinical Pharmacology (12.1)*], treatment with aflibercept may pose a risk to human embryofetal development.

OPUVIZ should be used during pregnancy only if the potential benefit justifies the potential risk to the fetus.

All pregnancies have a background risk of birth defect, loss, or other adverse outcomes. The background risk of major birth defects and miscarriage for the indicated population is unknown. In the U.S. general population, the estimated background risk of major birth defects and miscarriage in clinically recognized pregnancies is 2-4% and 15-20%, respectively.

Data

Animal Data

In two embryofetal development studies, aflibercept produced adverse embryofetal effects when administered every three days during organogenesis to pregnant rabbits at intravenous doses ≥ 3 mg per kg, or every six days during organogenesis at subcutaneous doses ≥ 0.1 mg per kg.

Adverse embryofetal effects included increased incidences of postimplantation loss and fetal malformations, including anasarca, umbilical hernia, diaphragmatic hernia, gastroschisis, cleft palate, ectrodactyly, intestinal atresia, spina bifida, encephalomeningocele, heart and major vessel defects, and skeletal malformations (fused vertebrae, sternebrae, and ribs; supernumerary vertebral arches and ribs; and incomplete ossification). The maternal No Observed Adverse Effect Level (NOAEL) in these studies was 3 mg per kg. Aflibercept produced fetal malformations at all doses assessed in rabbits and the fetal NOAEL was not identified. At the lowest dose shown to produce adverse embryofetal effects in rabbits (0.1 mg per kg), systemic exposure (AUC) of free aflibercept was approximately 6 times higher than systemic exposure (AUC) observed in adult patients after a single intravitreal dose of 2 mg.

8.2 Lactation

Risk Summary

There is no information regarding the presence of aflibercept products in human milk, the effects of the drug on the breastfed infant, or the effects of the drug on milk production/excretion. Because many drugs are excreted in human milk, and because the potential for absorption and harm to infant growth and development exists, OPUVIZ is not recommended during breastfeeding.

The developmental and health benefits of breastfeeding should be considered along with the mother's clinical need for OPUVIZ and any potential adverse effects on the breastfed child from OPUVIZ.

8.3 Females and Males of Reproductive Potential

Contraception

Females of reproductive potential are advised to use effective contraception prior to the initial dose, during treatment, and for at least 3 months after the last intravitreal injection of OPUVIZ.

Infertility

There are no data regarding the effects of aflibercept on human fertility. Aflibercept adversely affected female and male reproductive systems in cynomolgus monkeys when administered by intravenous injection at a dose approximately 1500 times higher than the systemic level observed in adult patients with an intravitreal dose of 2 mg. A No Observed Adverse Effect Level (NOAEL) was not identified. These findings were reversible within 20 weeks after cessation of treatment [see *Nonclinical Toxicology (13.1)*].

8.4 Pediatric Use

A pediatric assessment for OPUVIZ demonstrates that OPUVIZ is safe and effective for pediatric patients in an indication for which EYLEA (aflibercept) is approved. However, OPUVIZ is not approved for such indication due to marketing exclusivity for EYLEA (aflibercept).

8.5 Geriatric Use

In the clinical studies, approximately 76% (2049/2701) of patients randomized to treatment with aflibercept were ≥ 65 years of age and approximately 46% (1250/2701) were ≥ 75 years of age. No significant differences in efficacy or safety were seen with increasing age in these studies.

10 OVERDOSAGE

Overdosing with increased injection volume may increase intraocular pressure. Therefore, in case of overdose, intraocular pressure should be monitored and if deemed necessary by the treating physician, adequate treatment should be initiated.

11 DESCRIPTION

Aflibercept-yszy is a recombinant fusion protein consisting of portions of human VEGF receptors 1 and 2 extracellular domains fused to the Fc portion of human IgG1 formulated as an iso-osmotic solution for intravitreal administration. Aflibercept-yszy is a dimeric glycoprotein with a protein molecular weight of 97 kilodaltons (kDa) and contains glycosylation, constituting an additional 15% of the total molecular mass, resulting in a total molecular weight of 115 kDa. Aflibercept-yszy is produced in recombinant Chinese hamster ovary (CHO) cells.

OPUVIZ (aflibercept-yszy) injection is a sterile, clear, and colorless to pale yellow solution. OPUVIZ does not contain anti-microbial preservative and is supplied as a sterile, aqueous solution for intravitreal injection in a single-dose glass vial designed to deliver 0.05 mL (50 microliters) of solution containing 2 mg of aflibercept-yszy in dibasic sodium phosphate (0.008 mg), monobasic sodium phosphate (0.040 mg), polysorbate 20 (0.015 mg), sucrose (4 mg) and water for injection, with a pH of 6.2.

12 CLINICAL PHARMACOLOGY

12.1 Mechanism of Action

Vascular endothelial growth factor-A (VEGF-A) and placental growth factor (PlGF) are members of the VEGF family of angiogenic factors that can act as mitogenic, chemotactic, and vascular permeability factors for endothelial cells. VEGF acts via two receptor tyrosine kinases, VEGFR-1 and VEGFR-2, present on the surface of endothelial cells. PlGF binds only to VEGFR-1, which is also present on the surface of leucocytes. Activation of these receptors by VEGF-A can result in neovascularization and vascular permeability.

Aflibercept products act as a soluble decoy receptor that binds VEGF-A and PlGF, and thereby can inhibit the binding and activation of these cognate VEGF receptors.

12.2 Pharmacodynamics

Neovascular (Wet) Age-Related Macular Degeneration (AMD)

In the clinical studies anatomic measures of disease activity improved similarly in all treatment groups from baseline to week 52. Anatomic data were not used to influence treatment decisions during the first year.

Macular Edema Following Retinal Vein Occlusion (RVO)

Reductions in mean retinal thickness were observed in COPERNICUS, GALILEO, and VIBRANT at week 24 compared to baseline. Anatomic data were not used to influence treatment decisions [see *Clinical Studies (14.2, 14.3)*].

Diabetic Macular Edema (DME)

Reductions in mean retinal thickness were observed in VIVID and VISTA at weeks 52 and 100 compared to baseline. Anatomic data were not used to influence aflibercept treatment decisions [see *Clinical Studies (14.4)*].

12.3 Pharmacokinetics

Aflibercept is administered intravitreally to exert local effects in the eye. In patients with wet AMD, RVO, or DME, following intravitreal administration of aflibercept, a fraction of the administered dose is expected to bind with endogenous VEGF in the eye to form an inactive aflibercept: VEGF complex. Once absorbed into the systemic circulation, aflibercept presents in the plasma as free aflibercept (unbound to VEGF) and a more predominant stable inactive form with circulating endogenous VEGF (i.e., aflibercept: VEGF complex).

Absorption/Distribution

Following intravitreal administration of 2 mg per eye of aflibercept to patients with wet AMD, RVO, and DME, the mean C_{max} of free aflibercept in the plasma was 0.02 mcg/mL (range: 0 to 0.054 mcg/mL), 0.05 mcg/mL (range: 0 to 0.081 mcg/mL), and 0.03 mcg/mL (range: 0 to 0.076 mcg/mL), respectively and was attained in 1 to 3 days. The free aflibercept plasma concentrations were undetectable two weeks post-dosing in all patients. Aflibercept did not accumulate in plasma when administered as repeated doses intravitreally every 4 weeks. It is estimated that after intravitreal administration of 2 mg to patients, the mean maximum plasma concentration of free aflibercept is more than 100 fold lower than the concentration of aflibercept required to half-maximally bind systemic VEGF.

The volume of distribution of free aflibercept following intravenous (I.V.) administration of aflibercept has been determined to be approximately 6L.

Metabolism/Elimination

Aflibercept is a therapeutic protein and no drug metabolism studies have been conducted. Aflibercept is expected to undergo elimination through both target-mediated disposition via binding to free endogenous VEGF and metabolism via proteolysis. The terminal elimination half-life (t_{1/2}) of free aflibercept in plasma was approximately 5 to 6 days after I.V. administration of doses of 2 to 4 mg/kg aflibercept.

Specific Populations

Renal Impairment

Pharmacokinetic analysis of a subgroup of patients (n=492) in one wet AMD study, of which 43% had renal impairment (mild n=120, moderate n=74, and severe n=16), revealed no differences with respect to plasma concentrations of free aflibercept after intravitreal administration every 4 or 8 weeks. Similar results were seen

in patients in a RVO study and in patients in a DME study. No dose adjustment based on renal impairment status is needed for either wet AMD, RVO, or DME patients.

Other

No dosage modification is required based on gender or in the elderly.

12.4 Immunogenicity

The observed incidence of anti-drug antibodies is highly dependent on the sensitivity and specificity of the assay. Differences in assay methods preclude meaningful comparisons of the incidence of anti-drug antibodies in the studies described below with the incidence of anti-drug antibodies in other studies, including those of aflibercept or of other aflibercept products.

In the wet AMD, RVO, and DME studies, the pre-treatment incidence of immunoreactivity to aflibercept was approximately 1% to 3% across treatment groups. After dosing with aflibercept for 24-100 weeks, antibodies to aflibercept were detected in a similar percentage range of patients.

There were no differences in efficacy or safety between patients with or without immunoreactivity.

13 NONCLINICAL TOXICOLOGY

13.1 Carcinogenesis, Mutagenesis, Impairment of Fertility

No studies have been conducted on the mutagenic or carcinogenic potential of aflibercept products. Effects on male and female fertility were assessed as part of a 6-month study in monkeys with intravenous administration of aflibercept at weekly doses ranging from 3 to 30 mg per kg. Absent or irregular menses associated with alterations in female reproductive hormone levels and changes in sperm morphology and motility were observed at all dose levels. In addition, females showed decreased ovarian and uterine weight accompanied by compromised luteal development and reduction of maturing follicles. These changes correlated with uterine and vaginal atrophy. A No Observed Adverse Effect Level (NOAEL) was not identified. Intravenous administration of the lowest dose of aflibercept assessed in monkeys (3 mg per kg) resulted in systemic exposure (AUC) for free aflibercept that was approximately 1500 times higher than the systemic exposure observed in adult patients after an intravitreal dose of 2 mg. All changes were reversible within 20 weeks after cessation of treatment.

13.2 Animal Toxicology and/or Pharmacology

Erosions and ulcerations of the respiratory epithelium in nasal turbinates in monkeys treated with aflibercept intravitreally were observed at intravitreal doses of 2 or 4 mg per eye. At the NOAEL of 0.5 mg per eye in monkeys, the systemic exposure (AUC) was 56 times higher than the exposure observed in adult patients after an intravitreal dose of 2 mg. Similar effects were not seen in clinical studies [*see Clinical Studies (14)*].

14 CLINICAL STUDIES

14.1 Neovascular (Wet) Age-Related Macular Degeneration (AMD)

The safety and efficacy of aflibercept were assessed in two randomized, multi-center, double-masked, active-controlled studies in patients with wet AMD. A total of 2412 patients were treated and evaluable for efficacy (1817 with aflibercept) in the two studies (VIEW1 and VIEW2). In each study, up to week 52, patients were randomly assigned in a 1:1:1:1 ratio to 1 of 4 dosing regimens: 1) aflibercept administered 2 mg every 8 weeks following 3 initial monthly doses (aflibercept 2Q8); 2) aflibercept administered 2 mg every 4 weeks (aflibercept 2Q4); 3) aflibercept 0.5 mg administered every 4 weeks (aflibercept 0.5Q4); and 4) ranibizumab administered 0.5 mg every 4 weeks (ranibizumab 0.5 mg Q4). Protocol- specified visits

occurred every 28±3 days. Patient ages ranged from 49 to 99 years with a mean of 76 years.

In both studies, the primary efficacy endpoint was the proportion of patients who maintained vision, defined as losing fewer than 15 letters of visual acuity at week 52 compared to baseline. Both aflibercept 2Q8 and aflibercept 2Q4 groups were shown to have efficacy that was clinically equivalent to the ranibizumab 0.5 mg Q4 group in year 1.

Detailed results from the analysis of the VIEW1 and VIEW2 studies are shown in [Table 4](#) and [Figure 8](#) below.

Table 4: Efficacy Outcomes at Week 52 (Full Analysis Set with LOCF) in VIEW1 and VIEW2 Studies

	VIEW1			VIEW2		
	Aflibercept 2 mg Q8 weeks ^a	Aflibercept 2 mg Q4 weeks	Ranibizumab 0.5 mg Q4 weeks	Aflibercept 2 mg Q8 weeks ^a	Aflibercept 2 mg Q4 weeks	Ranibizumab 0.5 mg Q4 weeks
Full Analysis Set	N=301	N=304	N=304	N=306	N=309	N=291
Efficacy Outcomes						
Proportion of patients who maintained visual acuity (%) (<15 letters of BCVA loss)	94%	95%	94%	95%	95%	95%
Difference ^b (%) (95.1% CI)	0.6 (-3.2, 4.4)	1.3 (-2.4, 5.0)		0.6 (-2.9, 4.0)	-0.3 (-4.0, 3.3)	
Mean change in BCVA as measured by ETDRS letter score from Baseline	7.9	10.9	8.1	8.9	7.6	9.4
Difference ^b in LS mean (95.1% CI)	0.3 (-2.0, 2.5)	3.2 (0.9, 5.4)		-0.9 (-3.1, 1.3)	-2.0 (-4.1, 0.2)	
Number of patients who gained at least 15 letters of vision from Baseline (%)	92 (31%)	114 (38%)	94 (31%)	96 (31%)	91 (29%)	99 (34%)
Difference ^b (%) (95.1% CI)	-0.4 (-7.7, 7.0)	6.6 (-1.0, 14.1)		-2.6 (-10.2, 4.9)	-4.6 (-12.1, 2.9)	

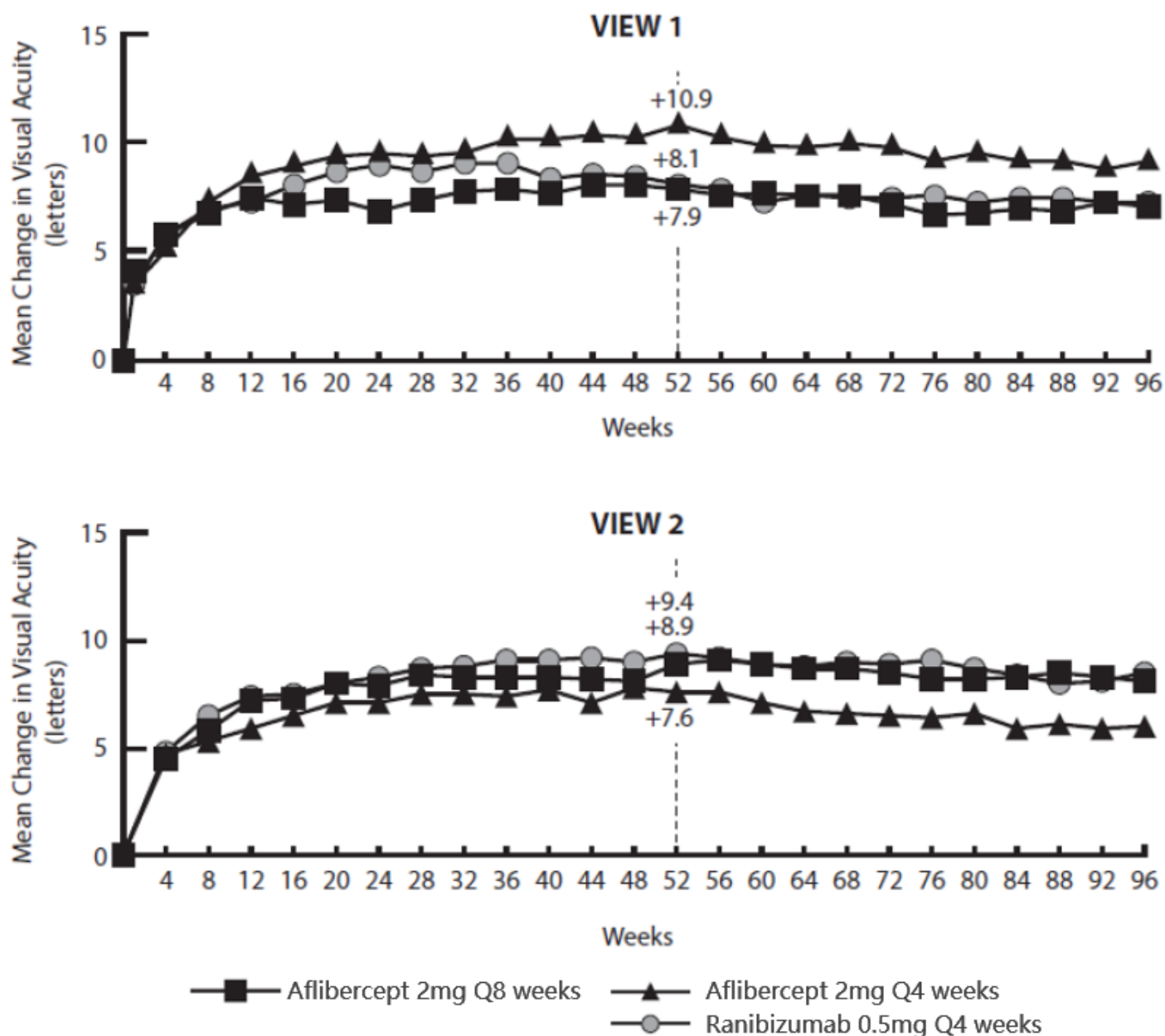
BCVA = Best Corrected Visual Acuity; CI = Confidence Interval; ETDRS = Early Treatment Diabetic Retinopathy Study; LOCF = Last Observation Carried Forward (baseline values are not carried forward); 95.1% confidence intervals were presented to adjust for safety assessment conducted during the study

^a After treatment initiation with 3 monthly doses

^b Aflibercept group minus the ranibizumab group

Treatment effects in evaluable subgroups (e.g., age, gender, race, baseline visual acuity) in each study were in general consistent with the results in the overall populations.

Figure 8: Mean Change in Visual Acuity from Baseline to Week 96* in VIEW1 and VIEW2 Studies



* Patient dosing schedules were individualized from weeks 52 to 96 using a modified 12-week dosing regimen.

VIEW1 and VIEW2 studies were both 96 weeks in duration. However, after 52 weeks patients no longer followed a fixed dosing schedule. Between week 52 and week 96, patients continued to receive the drug and dosage strength to which they were initially randomized on a modified 12 week dosing schedule (doses at least every 12 weeks and additional doses as needed). Therefore, during the second year of these studies there was no active control comparison arm.

14.2 Macular Edema Following Central Retinal Vein Occlusion (CRVO)

The safety and efficacy of aflibercept were assessed in two randomized, multi-center, double-masked, sham-

controlled studies in patients with macular edema following CRVO. A total of 358 patients were treated and evaluable for efficacy (217 with aflibercept) in the two studies (COPERNICUS and GALILEO). In both studies, patients were randomly assigned in a 3:2 ratio to either 2 mg aflibercept administered every 4 weeks (2Q4), or sham injections (control group) administered every 4 weeks for a total of 6 injections.

Protocol-specified visits occurred every 28±7 days. Patient ages ranged from 22 to 89 years with a mean of 64 years.

In both studies, the primary efficacy endpoint was the proportion of patients who gained at least 15 letters in BCVA compared to baseline. At week 24, the aflibercept 2 mg Q4 group was superior to the control group for the primary endpoint.

Results from the analysis of the COPERNICUS and GALILEO studies are shown in [Table 5](#) and [Figure 9](#) below.

Table 5: Efficacy Outcomes at Week 24 (Full Analysis Set with LOCF) in COPERNICUS and GALILEO Studies

	COPERNICUS		GALILEO	
	Control	Aflibercept 2 mg Q4 weeks	Control	Aflibercept 2 mg Q4 weeks
	N=73	N=114	N=68	N=103
Efficacy Outcomes				
Proportion of patients who gained at least 15 letters in BCVA from Baseline (%)	12%	56%	22%	60%
Weighted Difference ^{a, b} (%) (95.1% CI)		44.8% ^c (32.9, 56.6)		38.3% ^c (24.4, 52.1)
Mean change in BCVA as measured by ETDRS letter score from Baseline (SD)	-4.0 (18.0)	17.3 (12.8)	3.3 (14.1)	18.0 (12.2)
Difference in LS mean ^{a, d} (95.1% CI)		21.7 ^c (17.3, 26.1)		14.7 ^c (10.7, 18.7)

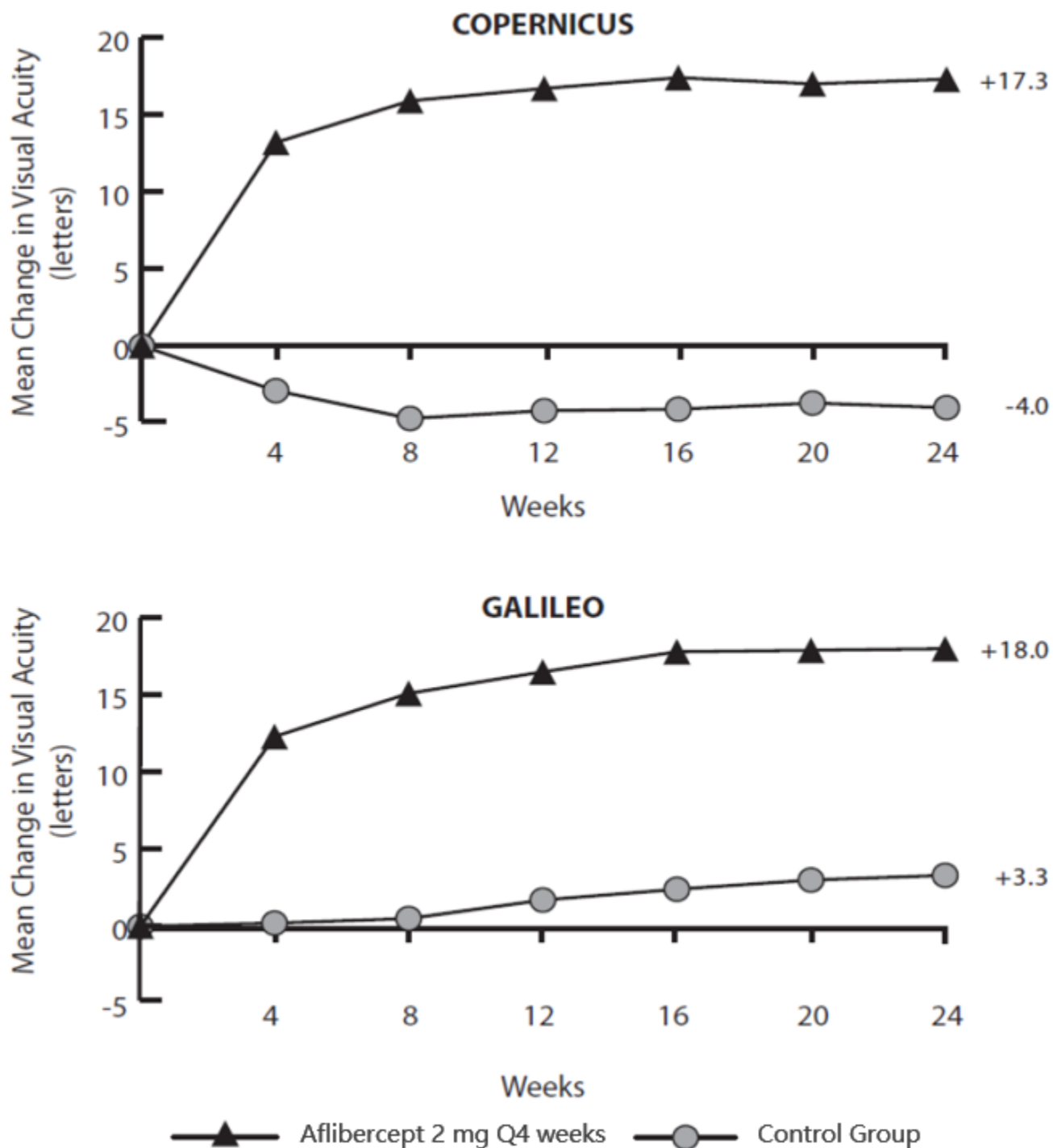
^a Difference is aflibercept 2 mg Q4 weeks minus Control

^b Difference and CI are calculated using Cochran-Mantel-Haenszel (CMH) test adjusted for baseline factors; 95.1% confidence intervals were presented to adjust for the multiple assessments conducted during the study

^c p<0.01 compared with Control

^d LS mean and CI based on an ANCOVA model

Figure 9: Mean Change in BCVA as Measured by ETDRS Letter Score from Baseline to Week 24 in COPERNICUS and GALILEO Studies



Treatment effects in evaluable subgroups (e.g., age, gender, race, baseline visual acuity, retinal perfusion status, and CRVO duration) in each study and in the combined analysis were in general consistent with the results in the overall populations.

14.3 Macular Edema Following Branch Retinal Vein Occlusion (BRVO)

The safety and efficacy of aflibercept were assessed in a 24-week, randomized, multi-center, double-masked, controlled study in patients with macular edema following BRVO. A total of 181 patients were treated and evaluable for efficacy (91 with aflibercept) in the VIBRANT study. In the study, patients were randomly assigned in a 1:1 ratio to either 2 mg aflibercept administered every 4 weeks (2Q4) or laser photocoagulation administered at baseline and subsequently as needed (control group). Protocol-specified visits occurred every 28±7 days. Patient ages ranged from 42 to 94 years with a mean of 65 years.

In the VIBRANT study, the primary efficacy endpoint was the proportion of patients who gained at least 15 letters in BCVA at week 24 compared to baseline. At week 24, the aflibercept 2 mg Q4 group was superior to the control group for the primary endpoint.

Detailed results from the analysis of the VIBRANT study are shown in [Table 6](#) and [Figure 10](#) below.

Table 6: Efficacy Outcomes at Week 24 (Full Analysis Set with LOCF) in VIBRANT Study

	VIBRANT	
	Control	Aflibercept 2 mg Q4 weeks
	N=90	N=91
Efficacy Outcomes		
Proportion of patients who gained at least 15 letters in BCVA from Baseline (%)	26.7%	52.7%
Weighted Difference ^{a, b} (%) (95% CI)		26.6% ^c (13.0, 40.1)
Mean change in BCVA as measured by ETDRS letter score from Baseline (SD)	6.9 (12.9)	17.0 (11.9)
Difference in LS mean ^{a, d} (95% CI)		10.5 ^d (7.1, 14.0)

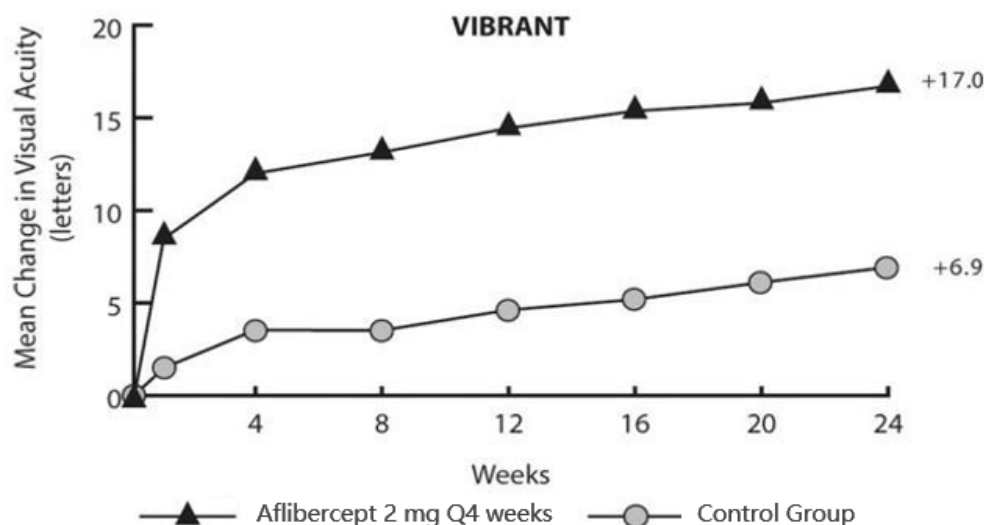
^a Difference is aflibercept 2 mg Q4 weeks minus Control

^b Difference and CI are calculated using Mantel-Haenszel weighting scheme adjusted for region (North America vs. Japan) and baseline BCVA category (> 20/200 and ≤ 20/200)

^c p<0.01 compared with Control

^d LS mean and CI based on an ANCOVA model

Figure 10: Mean Change in BCVA as Measured by ETDRS Letter Score from Baseline to Week 24 in VIBRANT Study



Treatment effects in evaluable subgroups (e.g., age, gender, and baseline retinal perfusion status) in the study were in general consistent with the results in the overall populations.

14.4 Diabetic Macular Edema (DME)

The safety and efficacy of aflibercept were assessed in two randomized, multi-center, double-masked, controlled studies in patients with DME. A total of 862 randomized and treated patients were evaluable for efficacy. Protocol-specified visits occurred every 28 ± 7 days. Patient ages ranged from 23 to 87 years with a mean of 63 years.

Of those, 576 were randomized to aflibercept groups in the two studies (VIVID and VISTA). In each study, patients were randomly assigned in a 1:1:1 ratio to 1 of 3 dosing regimens: 1) aflibercept administered 2 mg every 8 weeks following 5 initial monthly injections (aflibercept 2Q8); 2) aflibercept administered 2 mg every 4 weeks (aflibercept 2Q4); and 3) macular laser photocoagulation (at baseline and then as needed). Beginning at week 24, patients meeting a pre-specified threshold of vision loss were eligible to receive additional treatment: patients in the aflibercept groups could receive laser and patients in the laser group could receive aflibercept.

In both studies, the primary efficacy endpoint was the mean change from baseline in BCVA at week 52 as measured by ETDRS letter score. Efficacy of both aflibercept 2Q8 and aflibercept 2Q4 groups was statistically superior to the control group. This statistically superior improvement in BCVA was maintained at week 100 in both studies.

Results from the analysis of the VIVID and VISTA studies are shown in [Table 7](#) and [Figure 11](#) below.

Table 7: Efficacy Outcomes at Weeks 52 and 100 (Full Analysis Set with LOCF) in VIVID and VISTA Studies

	VIVID			VISTA		
	Aflibercept 2 mg Q8 weeks ^a	Aflibercept 2 mg Q4 weeks	Control	Aflibercept 2 mg Q8 weeks ^a	Aflibercept 2 mg Q4 weeks	Control
Full Analysis Set	N=135	N=136	N=132	N=151	N=154	N=154
Efficacy Outcomes at Week 52						
Mean change in BCVA as measured by ETDRS letter score from Baseline (SD)	10.7 (9.3)	10.5 (9.6)	1.2 (10.6)	10.7 (8.2)	12.5 (9.5)	0.2 (12.5)
Difference ^{b, c} in LS mean (97.5% CI)	9.1 ^d (6.3, 11.8)	9.3 ^d (6.5, 12.0)		10.5 ^d (7.7, 13.2)	12.2 ^d (9.4, 15.0)	
Proportion of patients who gained at least 15 letters in BCVA from Baseline (%)	33.3%	32.4%	9.1%	31.1%	41.6%	7.8%
Adjusted Difference ^{c, e} (%) (97.5% CI)	24.2% ^d (13.5, 34.9)	23.3% ^d (12.6, 33.9)		23.3% ^d (13.5, 33.1)	34.2% ^d (24.1, 44.4)	
Efficacy Outcomes at Week 100						
Mean change in BCVA as measured by ETDRS letter score from Baseline (SD)	9.4 (10.5)	11.4 (11.2)	0.7 (11.8)	11.1 (10.7)	11.5 (13.8)	0.9 (13.9)
Difference ^{b, c} in LS mean (97.5% CI)	8.2 ^d (5.2, 11.3)	10.7 ^d (7.6, 13.8)		10.1 ^d (7.0, 13.3)	10.6 ^d (7.1, 14.2)	
Proportion of patients who gained at least 15 letters in BCVA from Baseline (%)	31.1%	38.2%	12.1%	33.1%	38.3%	13.0%
Adjusted Difference ^{c, e} (%) (97.5% CI)	19.0% ^d (8.0, 29.9)	26.1% ^d (14.8, 37.5)		20.1% ^d (9.6, 30.6)	25.8% ^d (15.1, 36.6)	

^a After treatment initiation with 5 monthly injections

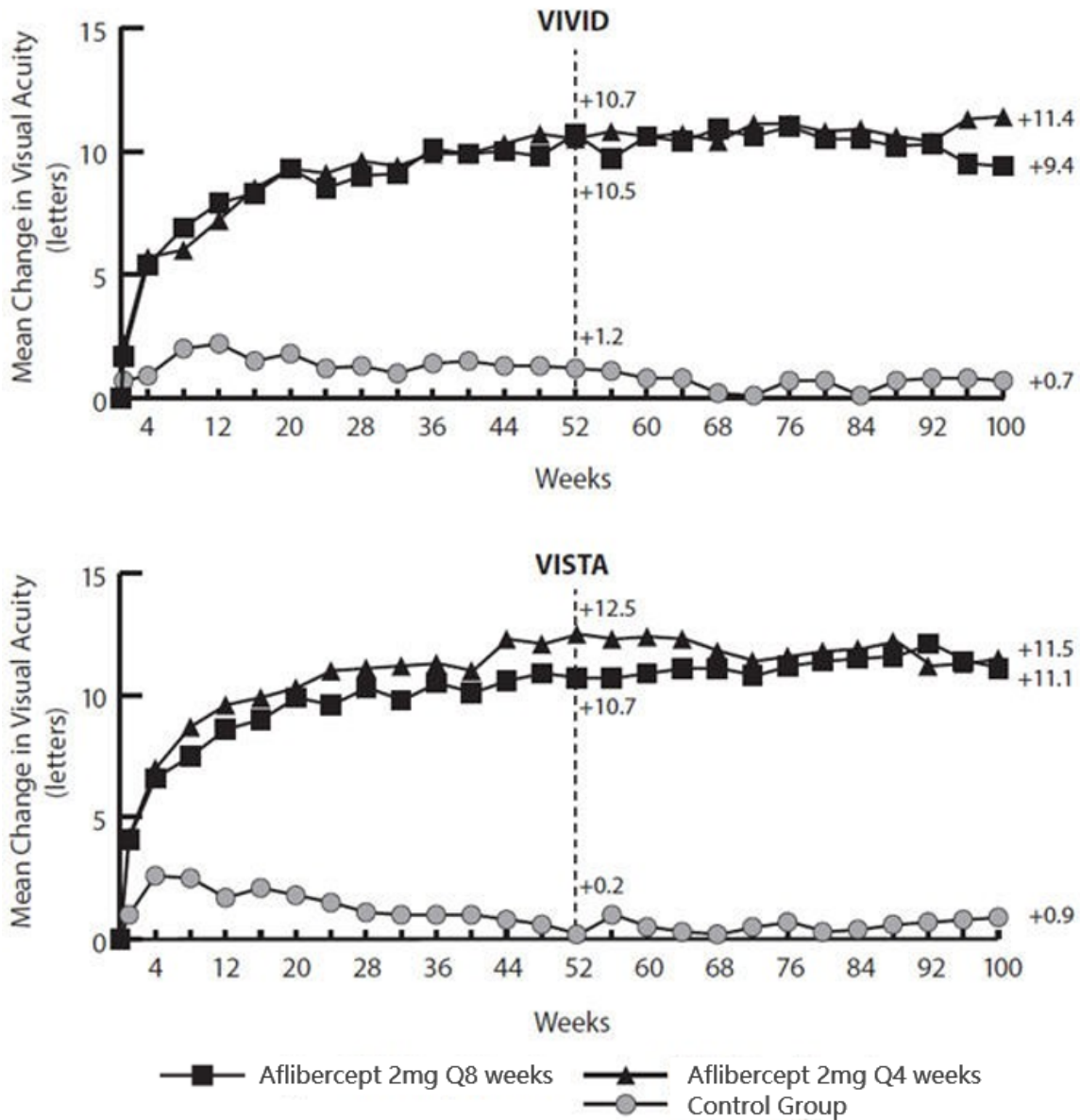
^b LS mean and CI based on an ANCOVA model with baseline BCVA measurement as a covariate and a factor for treatment group. Additionally, protocol specified stratification factors were included in the model

^c Difference is aflibercept group minus Control group

^d p<0.01 compared with Control

^e Difference with confidence interval (CI) and statistical test is calculated using Mantel-Haenszel weighting scheme adjusted by protocol specified stratification factors

Figure 11: Mean Change in BCVA as Measured by ETDRS Letter Score from Baseline to Week 100 in VIVID and VISTA Studies



Treatment effects in the subgroup of patients who had previously been treated with a VEGF inhibitor prior to study participation were similar to those seen in patients who were VEGF inhibitor naïve prior to study participation.

Treatment effects in evaluable subgroups (e.g., age, gender, race, baseline HbA1c, baseline visual acuity, prior anti-VEGF therapy) in each study were in general consistent with the results in the overall populations.

14.5 Diabetic Retinopathy (DR)

Efficacy and safety data of aflibercept in diabetic retinopathy (DR) are derived from the VIVID, VISTA, and PANORAMA studies.

VIVID AND VISTA

In the VIVID and VISTA studies, an efficacy outcome was the change in the Early Treatment Diabetic Retinopathy Study (ETDRS) Diabetic Retinopathy Severity Scale (ETDRS-DRSS). The ETDRS-DRSS score was assessed at baseline and approximately every 6 months thereafter for the duration of the studies [see *Clinical Studies (14.4)*].

All enrolled patients had DR and DME at baseline. The majority of patients enrolled in these studies (77%) had moderate-to-severe nonproliferative diabetic retinopathy (NPDR) based on the ETDRS-DRSS. At week 100, the proportion of patients improving by at least 2 steps on the ETDRS-DRSS was significantly greater in both aflibercept treatment groups (2Q4 and 2Q8) when compared to the control group.

Results from the analysis of ETDRS-DRSS at week 100 in the VIVID and VISTA studies are shown in Table 8 below.

Table 8: Proportion of Patients Who Achieved a ≥ 2 -Step Improvement from Baseline in the ETDRS-DRSS Score at Week 100 in VIVID and VISTA Studies

	VIVID			VISTA		
	Aflibercept 2 mg Q8 weeks ^a	Aflibercept 2 mg Q4 weeks	Control	Aflibercept 2 mg Q8 weeks ^a	Aflibercept 2 mg Q4 weeks	Control
Evaluable Patients ^b	N=101	N=97	N=99	N=148	N=153	N=150
Number of patients with a ≥ 2 -step improvement on ETDRS-DRSS from Baseline (%)	32 (32%)	27 (28%)	7 (7%)	56 (38%)	58 (38%)	24 (16%)
Difference ^{c, d} (%) (97.5% CI)	24% ^e (12, 36)	21% ^e (9, 33)		22% ^e (11, 33)	22% ^e (11, 33)	

Non-gradable post-baseline ETDRS-DRSS values were treated as missing and were imputed using the last gradable ETDRS-DRSS values (including baseline values if all post-baseline values were missing or non-gradable)

^a After treatment initiation with 5 monthly injections

^b The number of evaluable patients included all patients who had valid ETDRS-DRSS data at baseline

^c Difference with confidence interval (CI) was calculated using Mantel-Haenszel weighting scheme adjusted by protocol specified stratification factors

^d Difference is aflibercept minus Control group

^e $p < 0.01$ compared with Control

Results of the evaluable subgroups (e.g., age, gender, race, baseline HbA1c, baseline visual acuity) on the proportion of patients who achieved a ≥ 2 -step improvement on the ETDRS-DRSS from baseline to week 100 were, in general, consistent with those in the overall population.

PANORAMA

The PANORAMA study assessed the safety and efficacy of aflibercept in a randomized, multi-center, double-masked, controlled study in patients with moderately severe to severe nonproliferative diabetic retinopathy (NPDR) (ETDRS-DRSS of 47 or 53), without central-involved DME (CI-DME). A total of 402 randomized patients were evaluable for efficacy.

Protocol-specified visits occurred every 28 ± 7 days for the first 5 visits, then every 8 weeks (56 ± 7 days). Patient ages ranged from 25 to 85 years with a mean of 55.7 years.

Patients were randomly assigned in a 1:1:1 ratio to 1 of 3 dosing regimens: 1) 3 initial monthly aflibercept 2 mg injections followed by one injection after 8 weeks and then one injection every 16 weeks (aflibercept

2Q16); 2) 5 monthly aflibercept 2 mg injections followed by one injection every 8 weeks (aflibercept 2Q8); and 3) sham treatment.

The primary efficacy endpoint was the proportion of patients who improved by ≥ 2 steps on the DRSS from baseline to week 24 in the combined aflibercept groups and at week 52 in the 2Q16 and 2Q8 groups individually versus sham. A key secondary endpoint was the proportion of patients developing the composite endpoint of proliferative diabetic retinopathy or anterior segment neovascularization through week 52.

At week 52, efficacy in the 2Q16 and 2Q8 groups was superior to the sham group (see [Table 9](#) and [Table 10](#)). The proportion of patients with a ≥ 2 -step improvement over time is shown in [Figure 12](#).

Table 9: Proportion of Patients Who Achieved a ≥ 2 -Step Improvement from Baseline in the ETDRS-DRSS Score at Weeks 24 and 52 in PANORAMA

	PANORAMA				
	Week 24		Week 52		
	Aflibercept Combined	Control (sham)	Aflibercept 2Q16	Aflibercept 2Q8	Control (sham)
Full Analysis Set	N=269	N=133	N=135	N=134	N=133
Proportion of patients with a ≥ 2 -step improvement on ETDRS-DRSS from Baseline (%)	58%	6%	65%	80%	15%
Adjusted Difference ^a (%) (95% CI) ^b	52% ^c (45, 60)		50% ^c (40, 60)	65% ^c (56, 74)	

Non-gradable post-baseline ETDRS-DRSS values were treated as missing and were imputed using the last gradable ETDRS-DRSS values (including baseline values if all post-baseline values were missing or non-gradable)

^a Difference is aflibercept group minus sham

^b Difference with CI was calculated using the Mantel-Haenszel weighting scheme adjusted by baseline DRSS stratification variable

^c $p < 0.01$ compared with Control. p-value was calculated using a 2-sided Cochran-Mantel-Haenszel test adjusted by baseline DRSS stratification variable.

Figure 12: Proportion of Patients Who Achieved a ≥ 2 -Step Improvement from Baseline in the ETDRS-DRSS Score Through Week 52 in PANORAMA

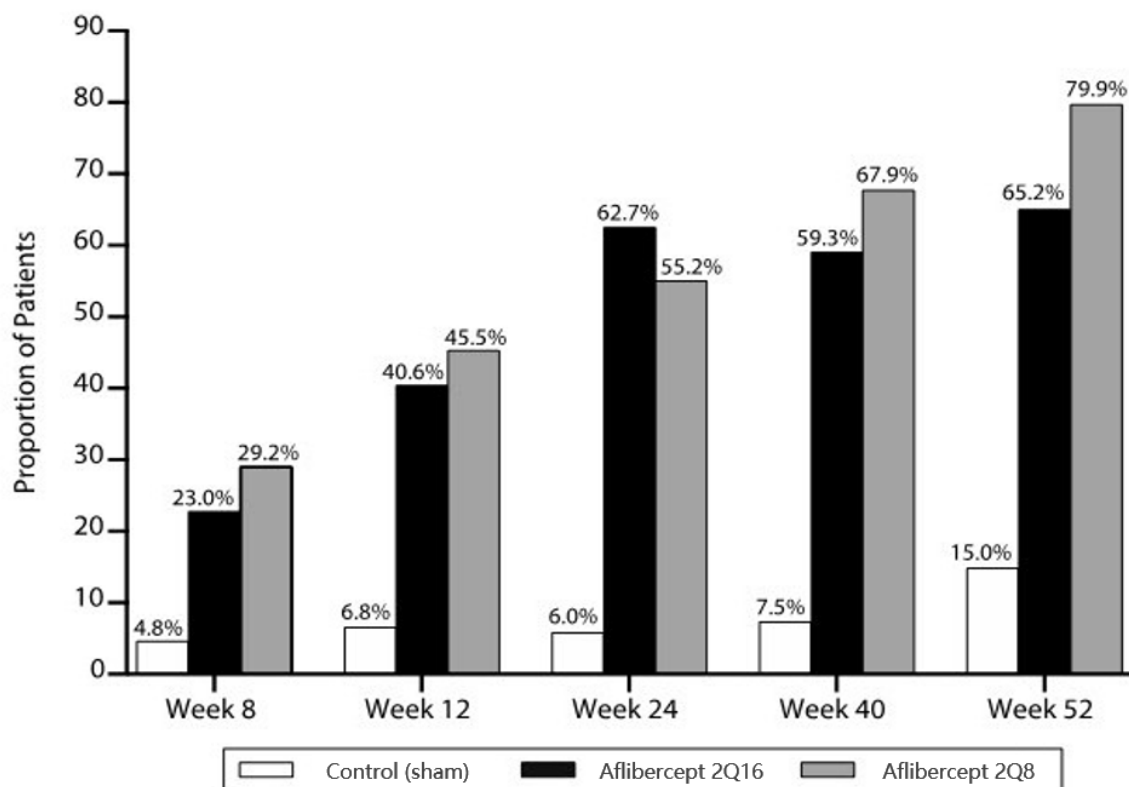


Table 10: Effect of Aflibercept on Worsening of Diabetic Retinopathy in PANORAMA through Week 52

	Aflibercept 2Q16	Aflibercept 2Q8	Control (Sham)
Full Analysis Set	N=135	N=134	N=133
Composite Endpoint of Developing PDR or ASNV ^a			
Event Rate ^b	4.0% ^d	2.4% ^d	20.1%
Hazard Ratio	0.15	0.12	
Development of Proliferative Diabetic Retinopathy ^c			
Event Rate ^b	1.6% ^d	0.0% ^d	11.9%
Hazard Ratio	0.11	0.00	

PDR = Proliferative Diabetic Retinopathy; ASNV = Anterior Segment Neovascularization

^a As diagnosed by either the Reading Center or Investigator through week 52

^b Estimated using Kaplan-Meier method

^c Defined as ≥ 2 -step worsening on the ETDRS-DRSS score through week 52

^d $p < 0.01$ compared with Control

16 HOW SUPPLIED/STORAGE AND HANDLING

16.1 How Supplied

Each vial is for single eye use only. Discard unused portion. OPUVIZ injection is a clear, colorless to pale yellow solution and is supplied in the following presentations [see *Dosage and Administration (2.6)*, and *(2.7)*]:

NDC NUMBER	CARTON TYPE	CARTON CONTENTS
64406-028-01	Vial Kit with Injection Components	one OPUVIZ 2 mg (0.05 mL of a 40 mg/mL solution) single-dose glass vial one 18-gauge × 1½-inch, 5-micron, filter needle for withdrawal of the vial contents one 30-gauge × ½-inch injection needle for intravitreal injection one 1-mL syringe for administration one Prescribing Information
64406-028-03	Vial Only	one OPUVIZ 2 mg (0.05 mL of a 40 mg/mL solution) single-dose glass vial one Prescribing Information

16.2 Storage and Handling

Refrigerate OPUVIZ at 2°C to 8°C (36°F to 46°F). Do not freeze. Do not use beyond the date stamped on the carton and container label. Store in the original carton until time of use to protect from light.

17 PATIENT COUNSELING INFORMATION

In the days following OPUVIZ administration, patients are at risk of developing endophthalmitis, retinal detachment, or retinal vasculitis with or without occlusion. If the eye becomes red, sensitive to light, painful, or develops a change in vision, advise patients and/or caregivers to seek immediate care from an ophthalmologist [see *Warnings and Precautions (5.1)*].

Patients may experience temporary visual disturbances after an intravitreal injection with OPUVIZ and the associated eye examinations [see *Adverse Reactions (6)*]. Advise patients not to drive or use machinery until visual function has recovered sufficiently.

OPUVIZ (afibercept-yszy)

Manufactured by:

Samsung Bioepis Co., Ltd.

76, Songdogyoyuk-ro,

Yeonsu-gu, Incheon, 21987

Republic of Korea

US License No. 2046

Manufactured for:

Biogen MA Inc.

225 Binney Street, Cambridge

MA, 02142

United States

OPUVIZ is a trademark of Biogen MA Inc.