

HIGHLIGHTS OF PRESCRIBING INFORMATION

These highlights do not include all the information needed to use TEPADINA® safely and effectively. See full prescribing information for TEPADINA®.

TEPADINA® (thiotepa) for injection, for intravenous, intracavitary, or intravesical use.

Initial U.S. Approval: 1959

WARNING: SEVERE MYELOSUPPRESSION and CARCINOGENICITY

See full prescribing information for complete boxed warning.

- May cause severe marrow suppression or ablation with resulting infection or bleeding. Monitor hematologic laboratory parameters. (5.1)
- Potentially carcinogenic in humans. (5.7)

RECENT MAJOR CHANGES

Dosage and Administration, Preparation Instructions (2.2)	4/2025
Dosage and Administration, Instruction for Use of the Multichamber Flexible Bag (2.3)	4/2025

INDICATIONS AND USAGE

TEPADINA (thiotepa) is an alkylating drug indicated:

- To reduce the risk of graft rejection when used in conjunction with high-dose busulfan and cyclophosphamide as a preparative regimen for allogeneic hematopoietic progenitor (stem) cell transplantation (HSCT) for pediatric patients with class 3 beta-thalassemia. (1.1, 14)
- For treatment of adenocarcinoma of the breast or ovary. (1.2)
- For controlling intracavitary effusions secondary to diffuse or localized neoplastic diseases of various serosal cavities. (1.3)
- For treatment of superficial papillary carcinoma of the urinary bladder. (1.4)

DOSAGE AND ADMINISTRATION

- The recommended dosage of TEPADINA for class 3 beta-thalassemia is two administrations of 5 mg/kg given by intravenous infusion approximately 12 hours apart on Day -6 before allogeneic HSCT in conjunction with high-dose busulfan and cyclophosphamide. (2.1)
- The recommended dosage of TEPADINA for treatment of adenocarcinoma of the breast or ovary is 0.3 mg/kg to 0.4 mg/kg by intravenous infusion. (2.1)
- The recommended dosage of TEPADINA for treatment of malignant effusions is 0.6 mg/kg to 0.8 mg/kg intracavitary. (2.1)
- The recommended dosage of TEPADINA for treatment of superficial

papillary carcinoma of the urinary bladder is 60 mg in 30 mL to 60 mL of 0.9% Sodium Chloride Injection into the bladder by catheter. (2.1)

- See Full Prescribing Information for preparation and administration instructions. (2.2, 2.3)

DOSAGE FORMS AND STRENGTHS

- For injection: 15 mg, lyophilized white powder in single-dose vial for reconstitution. (3)
- For injection: 100 mg, lyophilized white powder in single-dose vial for reconstitution. (3)
- For injection: 200 mg, lyophilized white powder and 200 mL 0.9% Sodium Chloride Injection in single-dose multichamber flexible bag for reconstitution. (3)

CONTRAINDICATIONS

- Hypersensitivity to the active substance. (4)
- Concomitant use with live or attenuated vaccines. (4)

WARNINGS AND PRECAUTIONS

- Cutaneous toxicity: Cleanse skin at least twice daily through 48 hours after the last dose of TEPADINA. (5.3)
- Embryo-Fetal toxicity: Can cause fetal harm. Advise females of reproductive potential and males with female partners of reproductive potential of the potential risk to a fetus and to use effective contraception. (5.8)

ADVERSE REACTIONS

The most common adverse reactions (incidence greater than 10%) are neutropenia, anemia, thrombocytopenia, elevated alanine aminotransferase, elevated aspartate aminotransferase, elevated bilirubin, mucositis, cytomegalovirus infection, hemorrhage, diarrhea, hematuria and rash. (6.1)

To report SUSPECTED ADVERSE REACTIONS, contact ADIENNE at 844-668-3940 or FDA at 1-800-FDA-1088 or www.fda.gov/medwatch.

USE IN SPECIFIC POPULATIONS

- Lactation: Advise not to breastfeed. (8.2)
- Moderate or severe renal impairment: Monitor patients more frequently for toxicity. (8.6, 12.3)
- Moderate or severe hepatic impairment: Monitor patients more frequently for toxicity. (8.7, 12.3)

See 17 for PATIENT COUNSELING INFORMATION

Revised: 4/2025

FULL PRESCRIBING INFORMATION: CONTENTS*

WARNING: SEVERE MYELOSUPPRESSION and CARCINOGENICITY

1 INDICATIONS AND USAGE

- 1.1 Class 3 beta-Thalassemia
- 1.2 Adenocarcinoma of the Breast or Ovary
- 1.3 Malignant Effusions
- 1.4 Superficial Papillary Carcinoma of the Urinary Bladder

2 DOSAGE AND ADMINISTRATION

- 2.1 Recommended Dosage
- 2.2 Preparation Instructions
- 2.3 Instructions for Use of the Multichamber Flexible Bag

3 DOSAGE FORMS AND STRENGTHS

4 CONTRAINDICATIONS

5 WARNINGS AND PRECAUTIONS

- 5.1 Myelosuppression
- 5.2 Hypersensitivity
- 5.3 Cutaneous Toxicity
- 5.4 Concomitant Use of Live and Attenuated Vaccines
- 5.5 Hepatic Venous Occlusive Disease

5.6 Central Nervous System Toxicity

5.7 Carcinogenicity

5.8 Embryo-Fetal Toxicity

6 ADVERSE REACTIONS

6.1 Clinical Trials Experience

6.2 Postmarketing Experience

7 DRUG INTERACTIONS

7.1 Effect of Cytochrome CYP3A Inhibitors and Inducers

7.2 Effect of TEPADINA on Cytochrome CYP2B6 Substrates

8 USE IN SPECIFIC POPULATIONS

8.1 Pregnancy

8.2 Lactation

8.3 Females and Males of Reproductive Potential

8.4 Pediatric Use

8.5 Geriatric Use

8.6 Renal Impairment

8.7 Hepatic Impairment

10 OVERDOSE

11 DESCRIPTION

12 CLINICAL PHARMACOLOGY

12.1 Mechanism of Action

12.2 Pharmacodynamics

12.3 Pharmacokinetics

13 NONCLINICAL TOXICOLOGY

13.1 Carcinogenesis, Mutagenesis, Impairment of Fertility

14 CLINICAL STUDIES

15 REFERENCES

16 HOW SUPPLIED/STORAGE AND HANDLING

17 PATIENT COUNSELING INFORMATION

*Sections or subsections omitted from the full prescribing information are not listed.

FULL PRESCRIBING INFORMATION

WARNING: SEVERE MYELOSUPPRESSION and CARCINOGENICITY

- TEPADINA may cause severe marrow suppression, and high doses may cause marrow ablation with resulting infection or bleeding. Monitor hematologic laboratory parameters. Hematopoietic progenitor (stem) cell transplantation (HSCT) is required to prevent potentially fatal complications of the prolonged myelosuppression after high doses of TEPADINA [see *Warnings and Precautions (5.1)*]
- TEPADINA should be considered potentially carcinogenic in humans [see *Warnings and Precautions (5.7)*]

1 INDICATIONS AND USAGE

1.1 Class 3 Beta-Thalassemia

TEPADINA is indicated to reduce the risk of graft rejection when used in conjunction with high-dose busulfan and cyclophosphamide as a preparative regimen for allogeneic hematopoietic progenitor (stem) cell transplantation (HSCT) for pediatric patients with class 3 beta-thalassemia [see *Clinical Studies (14)*].

1.2 Adenocarcinoma of the Breast or Ovary

TEPADINA is indicated for treatment of adenocarcinoma of the breast or ovary.

1.3 Malignant Effusions

TEPADINA is indicated for controlling intracavitary effusions secondary to diffuse or localized neoplastic diseases of various serosal cavities.

1.4 Superficial Papillary Carcinoma of the Urinary Bladder

TEPADINA is indicated for treatment of superficial papillary carcinoma of the urinary bladder.

2 DOSAGE AND ADMINISTRATION

2.1 Recommended Dosage

Class 3 Beta-Thalassemia

The recommended dosage of TEPADINA in pediatric patients is two administrations of 5 mg/kg given by intravenous infusion approximately 12 hours apart on Day -6 before allogeneic HSCT in conjunction with high-dose busulfan and cyclophosphamide as outlined in Table 1. See Prescribing Information for cyclophosphamide and busulfan for information on these drugs.

Table 1: Dosage Regimen For Allogeneic HSCT In Pediatric Patients With Class 3 Beta-Thalassemia

Treatment	Day prior to transplantation										
	Day -10	Day -9	Day -8	Day -7	Day -6	Day -5	Day -4	Day -3	Day -2	Day -1	Day 0
Busulfan intravenous weight-based dose *	▲	▲	▲	▲							
TEPADINA intravenous 5 mg/kg twice					▲						
Cyclophosphamide intravenous 40 mg/kg/day						▲	▲	▲	▲		
Stem cell Infusion											▲

*Busulfan intravenous weight-based dose: 1 mg/kg every 6 hours for patients less than 9 kg; 1.2 mg/kg every 6 hours for patients 9 kg to 16

kg; 1.1 mg/kg every 6 hours for patients 16.1 kg to 23 kg; 0.95 mg/kg every 6 hours for patients 23.1 kg to 34 kg; 0.8 mg/kg every 6 hours for patients more than 34 kg.

Infuse TEPADINA via a central venous catheter over 3 hours using an infusion set equipped with a 0.2 micron in-line filter. Prior to and following each infusion, flush the catheter with approximately 5 mL of 0.9% Sodium Chloride Injection.

TEPADINA is excreted through the skin of patients receiving high-dose therapy. Take precautions to prevent skin toxicity [see *Warnings and Precautions (5.3)*].

Adenocarcinoma of the Breast or Ovary

The recommended dosage of TEPADINA for treatment of adenocarcinoma of the breast or ovary is 0.3 mg/kg to 0.4 mg/kg by intravenous infusion. Doses should be given at 1 to 4 week intervals. Initially the higher dose in the given range is commonly administered. The maintenance dose should be adjusted weekly on the basis of pre-treatment control blood counts and subsequent blood counts. Maintenance dosages should not be administered more frequently than weekly.

Malignant Effusions

The recommended dosage of TEPADINA for treatment of malignant effusions is 0.6 mg/kg to 0.8 mg/kg intracavitary. Administration is usually effected through the same tubing which is used to remove the fluid from the cavity involved. Doses should be given at 1 to 4 week intervals. Initially the higher dose in the given range is commonly administered. The maintenance dose should be adjusted weekly on the basis of pre-treatment control blood counts and subsequent blood counts. Maintenance dosages should not be administered more frequently than weekly.

Superficial Papillary Carcinoma of the Urinary Bladder

The recommended dosage of TEPADINA for treatment of superficial papillary carcinoma of the urinary bladder is 60 mg in 30 mL to 60 mL of 0.9% Sodium Chloride Injection into the bladder by catheter. The solution should be retained for 2 hours. If the patient finds it impossible to retain 60 mL for 2 hours, the dose may be given in a volume of 30 mL. The patient may be repositioned every 15 minutes for maximum area contact. The usual course of treatment is once a week for 4 weeks. The course may be repeated if necessary, but second and third courses must be given with caution since bone-marrow depression may be increased.

2.2 Preparation Instructions

TEPADINA is a hazardous drug. Follow applicable special handling and disposal procedures.¹

Use appropriate aseptic technique.

Preparation from the Vial

- Reconstitution of the vial
 - Reconstitute each TEPADINA vial with Sterile Water for Injection using the volumes described in Table 2.

Table 2: Reconstitution Volumes for the Vials

Strength	Amount of Sterile Water for Injection required for reconstitution	Final concentration
15 mg vial	1.5 mL	10 mg/mL
100 mg vial	10 mL	10 mg/mL

- Mix the vial by repeated inversions until the powder is completely dissolved. Visually inspect reconstituted solution in the vial for particulate matter and discoloration. The reconstituted solution may occasionally show opalescence.

- Use the reconstituted solution immediately. If not used immediately, store the reconstituted solution in the vial refrigerated at 2°C to 8°C (36°F to 46°F), for up to 8 hours.
- Dilution of the reconstituted vial into an infusion bag
 - Withdraw the required volume of the reconstituted solution from the TEPADINA vial. Discard any unused portion.
 - Transfer the reconstituted solution into an intravenous bag containing 0.9% Sodium Chloride Injection to obtain a final concentration between 0.5 mg/mL and 1 mg/mL. Gently mix the intravenous bag by slowly inverting the bag.
 - Use the diluted solution immediately. If the diluted solution is not used immediately, store refrigerated at 2°C to 8°C (36°F to 46°F) for up to 24 hours or room temperature at 25°C (77°F) for up to 4 hours.
- Administration
 - Parenteral drug products should be inspected visually for particulate matter and discoloration prior to administration, whenever solution and container permit. Use TEPADINA diluted solutions only if free of visible particulate matter.
 - For intravenous administration of high doses in the preparative regimen for allogeneic HSCT for beta thalassemia, administer by intravenous infusion via central venous catheter over 3 hours using an infusion set equipped with 0.2 micron filter.
 - For intravesicular administration into the bladder by catheter, see further instructions in Dosage and Administration Section 2.1.
 - For all other indications, see further instructions in Dosage and Administration Section 2.1.

Preparation from the Multichamber Flexible Bag

See the Instructions for Use in Subsection 2.3 for illustrated steps for preparation and administration of TEPADINA from the multichamber flexible bag.

- Activation of the TEPADINA Multichamber Flexible Bag
 - Activate the multichamber flexible bag by pressing firmly and applying uniform pressure with the palms of your overlapped hands until the peel seal is broken.
 - Mix gently until the reconstituted solution is completely dissolved.
 - Administer TEPADINA immediately after reconstitution of the multichamber flexible bag. If not used immediately, store refrigerated at 2°C to 8°C (36°F to 46°F) for up to 168 hours or at room temperature at 20°C to 25°C (68°F to 77°F) up to 56 hours.
- Administration
 - Parenteral drug products should be inspected visually for particulate matter and discoloration prior to administration, whenever solution and container permit. Solution should be colorless and without particulate matter.
 - After activation, the resultant concentration is 200 mg/200 mL (1 mg/mL).
 - 200 mg dose can be directly administered from the multichamber flexible bag after activation.
 - For doses other than 200 mg, withdraw the patient-specific dose from the multichamber flexible bag for transfer to a separate empty bag for administration. No further dilution is necessary.
 - Administer using a 0.2 micron filter.

Section 2.3 Instructions for Use of the Multichamber Flexible Bag:

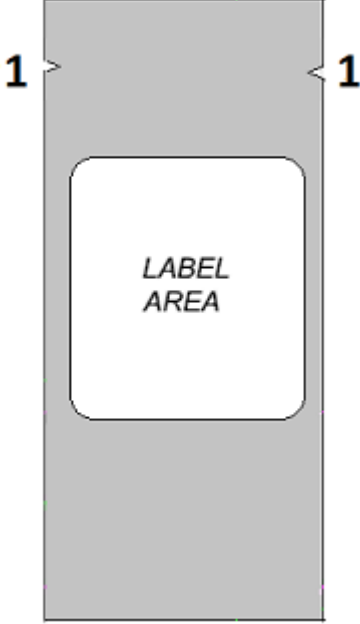
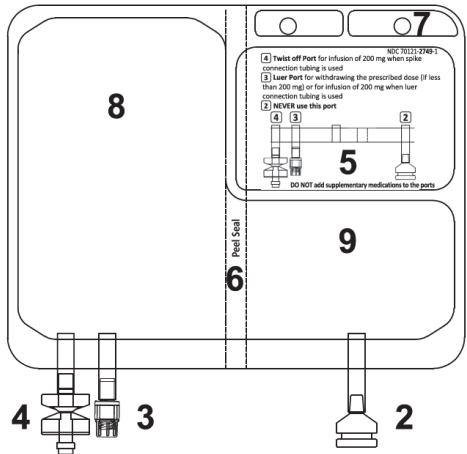
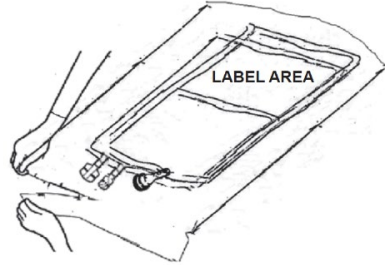
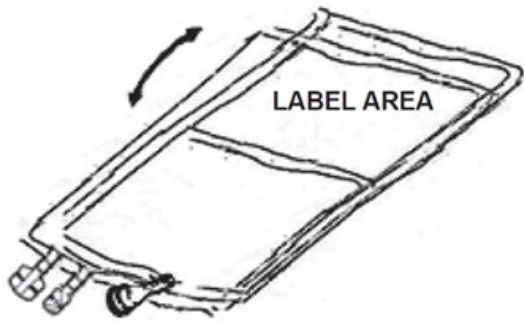
Multichamber Flexible Bag Use Instructions	
<p>Figure A</p> <p>1 - Overwrap Notch</p> 	<p>Figure B</p> <p>2 – NEVER use this port 3 – Luer Port 4 – Twist off Port 5 – Label Area 6 – Peel Seal (Must break to activate) 7 – Hole (For hanging the bag) 8 – Diluent chamber 9 – Lyophilized powder chamber</p> <p>TEPADINA 200 mg</p> 
1 – REMOVE OVERWRAP	
<p>a) Place bag on a clean, stable surface before opening.</p> <p>b) Tear from overwrap notch, located close to the ports (Figure A – point 1).</p> <p>c) Tear short sides open to access the inner bag as per Figure C.</p> <p>Figure C</p> 	<p>d) Remove the multichamber flexible bag from the aluminum overwrap and unfold the bag Figure D.</p> <p>Figure D</p> 

2 - INSPECT BAG PRIOR TO ACTIVATION	3 – ACTIVATE THE BAG
--	-----------------------------

Place bag on a clean, stable surface with the ports pointing away from you, as per **Figure E**. Check that there are no liquid or product leakages from the connection ports **2, 3, 4** and from the chambers **8, 9**. Check the integrity of peel seal **6**, verifying the absence of liquid in the chamber **9**.

Figure E

TEPADINA 200 mg

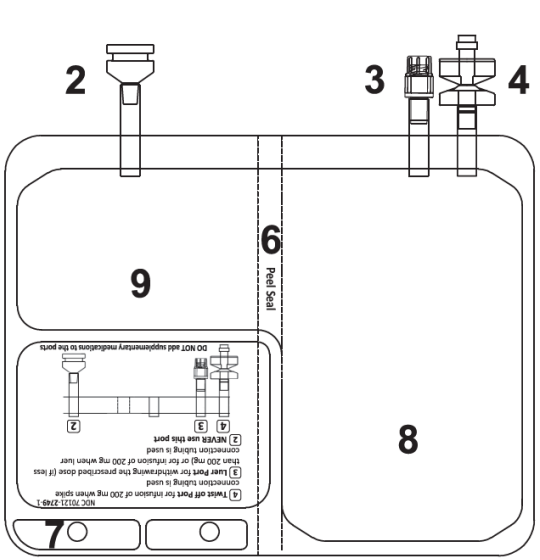

Overlap your hands, on the lower portion of chamber **8** (as per **Figure F**). Press firmly and apply uniform pressure until peel seal **6** is completely activated (it may take up to 5 seconds of continued pressure to break the peel seal **6**).

Figure F

TEPADINA 200 mg

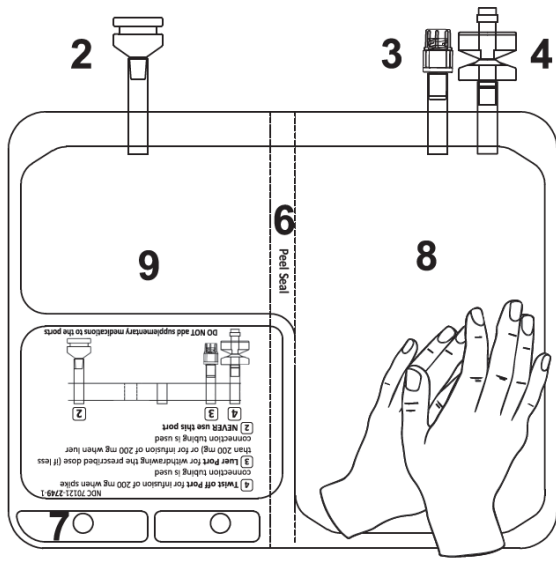

BAG BEFORE ACTIVATION	BAG AFTER ACTIVATION
------------------------------	-----------------------------

Figure G

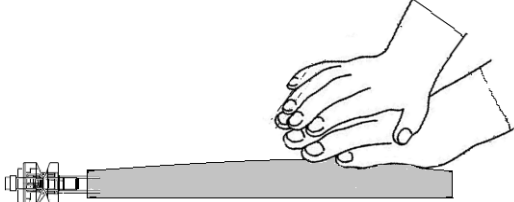
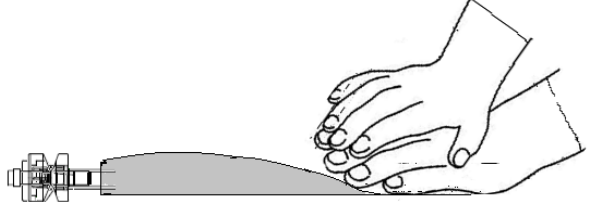
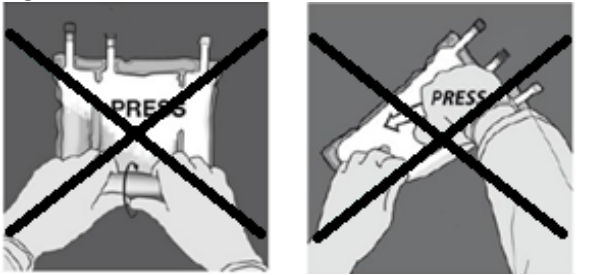

Figure H



Do NOT squeeze.

Figure I



4 – INSPECT BAG TO CONFIRM ACTIVATION

Check the peel seal **6** is now completely activated.
Chamber **8** and **9** are merged.
If the bag is not activated, refer to Step 3.

Figure J

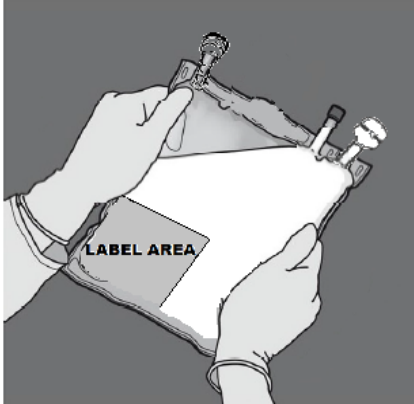

Mix gently until complete dissolution of product.

After activation, the resultant concentration is 1 mg/mL.

A dose of 200 mg may be directly infused from the bag (see Step 6). For doses less than 200 mg, see Step 5.

Figure K

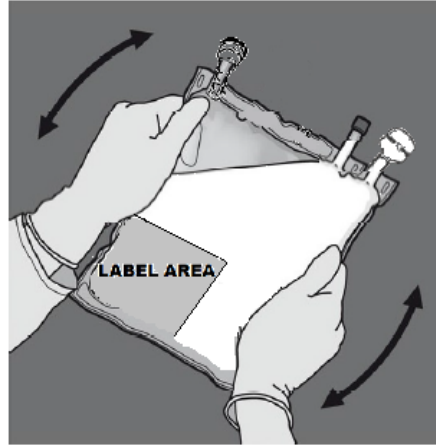

5 – DOSE PREPARATION – for doses less than 200 mg withdraw the patient-specific dose from the TEPADINA multichamber flexible bag and transfer to an appropriately-sized, empty, sterile bag for intravenous infusion.

Identify the Luer Port **3** if withdrawing a dose is needed.
Remove the plastic cap from Luer Port.

Figure L

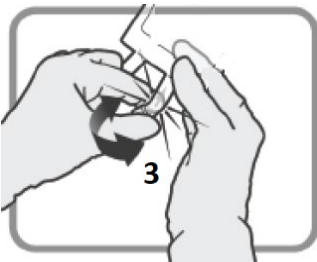

Screw the luer lock device as per Figure M.

Do not use improper non luer lock devices on port **3**.

Figure M

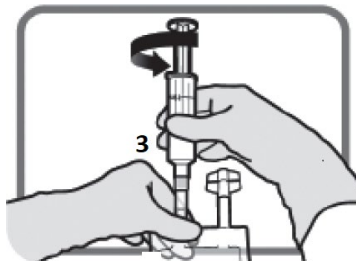

Ensure that the connection is fully seated and tighten.

Withdraw the desired dose from TEPADINA bag. This may require multiple graduated syringes depending on the desired dose. Unscrew each syringe counter-clockwise when finished.

Figure N

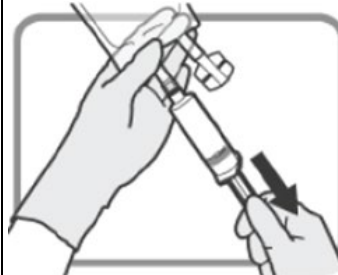

Replace the plastic cap on the Luer-Lock port **3**.

Attach a needle or an appropriate closed-system transfer device to

each syringe containing thiotepa solution and transfer the contents to an appropriately-sized, empty, sterile bag for intravenous infusion.

Discard the unused portion of the TEPADINA bag. Follow applicable special handling and disposal procedures.

6 – CONNECTION for administration of 200 mg - The infusion set may be connected to the bag through either the spike connector OR the luer connector.

OPTION A – SPIKE CONNECTION

Identify Twist off port 4.
Twist off the plastic cap before inserting the spike.

Figure O

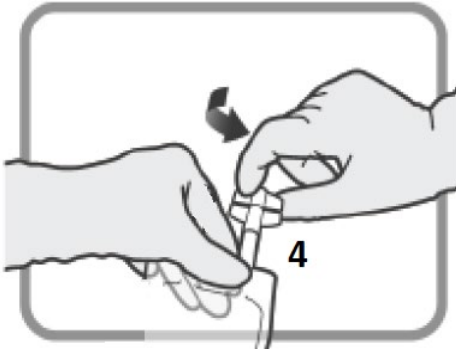

Insert the spike connector.

Figure P

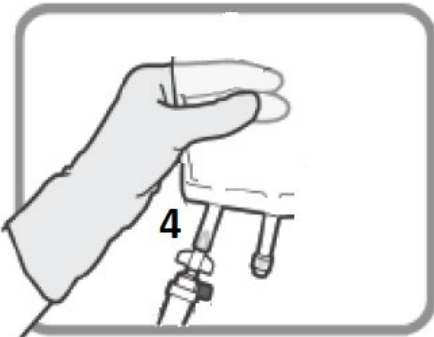

OPTION B– LUER CONNECTION

Select luer cap port 3.
Remove the plastic cap from luer port 3 before connecting the luer connector.

Figure Q

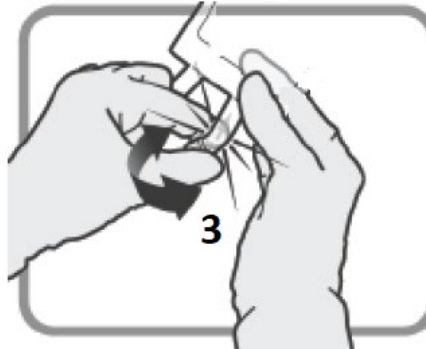

Insert the luer connector.

Figure R

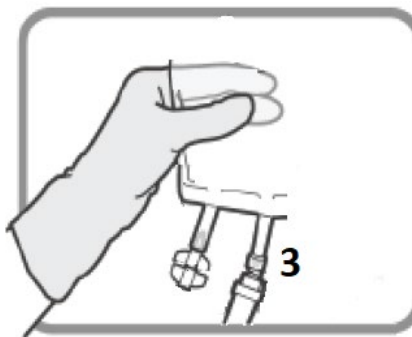

Ensure that the connection is fully seated and tighten.

7 – HANG THE BAG

Hang the bag by the hole 7.

Figure S

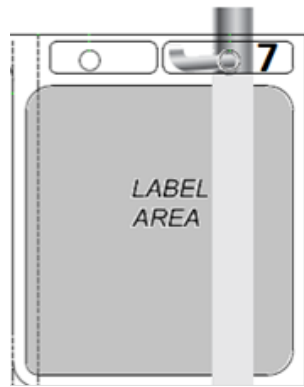

3 DOSAGE FORMS AND STRENGTHS

- For injection: 15 mg, lyophilized white powder in single-dose vial for reconstitution.
- For injection: 100 mg, lyophilized white powder in single-dose vial for reconstitution.
- For injection: 200 mg, lyophilized white powder thiotepa and 200 mL 0.9% Sodium Chloride Injection in single-dose multichamber flexible bag for reconstitution.

4 CONTRAINDICATIONS

TEPADINA is contraindicated in:

- Patients with severe hypersensitivity to thiotepa [*see Warnings and Precautions (5.2)*]
- Concomitant use with live or attenuated vaccines [*see Warnings and Precautions (5.4)*]

5 WARNINGS AND PRECAUTIONS

5.1 Myelosuppression

The consequence of treatment with high doses of TEPADINA together with other chemotherapy at the recommended dose and schedule in the preparative regimen for class 3 beta- thalassemia is profound myelosuppression occurring in all patients. Do not begin the preparative regimen if a stem cell donor is not available. Monitor complete blood counts, and provide supportive care for infections, anemia and thrombocytopenia until there is adequate hematopoietic recovery.

For patients receiving TEPADINA for treatment of adenocarcinoma of the breast, adenocarcinoma of the ovary, malignant effusions and superficial papillary carcinoma of the urinary bladder, if the bone marrow has been compromised by prior irradiation or chemotherapy, or is recovering from chemotherapy, the risk of severe myelosuppression with TEPADINA may be increased. Perform periodic complete blood counts during the course of treatment with TEPADINA. Provide supportive care for infections, bleeding, and symptomatic anemia [*see Adverse Reactions (6.1)*].

5.2 Hypersensitivity

Clinically significant hypersensitivity reactions, including anaphylaxis, have occurred following administration of TEPADINA. If anaphylactic or other clinically significant allergic reaction occurs, discontinue treatment with TEPADINA, initiate appropriate therapy, and monitor until signs and symptoms resolve [see *Contraindications (4)*, *Adverse Reactions (6.1)*].

5.3 Cutaneous Toxicity

TEPADINA and/or its active metabolites may be excreted in part via skin patients receiving high-dose therapy. Treatment with TEPADINA may cause skin discoloration, pruritus, blistering, desquamation, and peeling that may be more severe in the groin, axillae, skin folds, in the neck area, and under dressings. Instruct patients to shower or bathe with water at least twice daily through 48 hours after administration of TEPADINA. Change occlusive dressing and clean the covered skin at least twice daily through 48 hours after administration of TEPADINA. Change bed sheets daily during treatment.

Skin reactions associated with accidental exposure to TEPADINA may also occur. Wash the skin thoroughly with soap and water in case TEPADINA solution contacts the skin. Flush mucous membranes in case of TEPADINA contact with mucous membranes.

5.4 Concomitant Use of Live and Attenuated Vaccines

Do not administer live or attenuated viral or bacterial vaccines to a patient treated with TEPADINA until the immunosuppressive effects have resolved.

5.5 Hepatic Venno-Occlusive Disease

Hepatic venno-occlusive disease may occur in patients who have received high-dose TEPADINA in conjunction with busulfan and cyclophosphamide [see *Adverse Reactions (6.1)*]. Monitor by physical examination, serum transaminases and bilirubin daily through BMT Day +28, and provide supportive care to patients who develop hepatic venno-occlusive disease.

5.6 Central Nervous System Toxicity

Fatal encephalopathy has occurred in patients treated with high doses of thiotepa. Other central nervous system toxicities, such as headache, apathy, psychomotor retardation, disorientation, confusion, amnesia, hallucinations, drowsiness, somnolence, seizures, coma, inappropriate behaviour and forgetfulness have been reported to occur in a dose-dependent manner during or shortly after administration of high-dose thiotepa. In pediatric patients treated with TEPADINA at the recommended dose in combination with busulfan and cyclophosphamide, 8% developed central nervous system toxicity (seizures and intracranial hemorrhage). Do not exceed the recommended dose of TEPADINA. If severe or life-threatening central nervous system toxicity occurs, discontinue administration of TEPADINA and provide supportive care.

5.7 Carcinogenicity

Like many alkylating agents, thiotepa has been reported to be carcinogenic when administered to laboratory animals [see *Nonclinical Toxicity (13.1)*]. Carcinogenicity is shown most clearly in studies using mice, but there is some evidence of carcinogenicity in man. There is an increased risk of a secondary malignancy with use of TEPADINA.

5.8 Embryo-Fetal Toxicity

Based on the mechanism of action and findings in animals, TEPADINA can cause fetal harm when administered to a pregnant woman. There are no adequate and well-controlled studies of TEPADINA in pregnant women. Thiotepa given by the intraperitoneal (IP) route was teratogenic in mice at doses ≥ 1 mg/kg (3.2 mg/m²), approximately 8-fold less than the maximum recommended human therapeutic dose (0.8 mg/kg, 27 mg/m²), based on body-surface area. Thiotepa given by the IP route was teratogenic in rats at doses ≥ 3 mg/kg (21 mg/m²), approximately equal to the maximum recommended human therapeutic dose, based on body-surface area. Thiotepa was lethal to rabbit fetuses at a dose of 3 mg/kg (41 mg/m²),

approximately two times the maximum recommended human therapeutic dose based on body-surface area.

Advise pregnant women of the potential risk to the fetus [see *Use in Specific Populations (8.1, 8.3)*]. Advise females of reproductive potential to use highly effective contraception during and after treatment with TEPADINA for 6 months after therapy. Advise males of reproductive potential to use effective contraception during and after treatment with TEPADINA for 1 year after therapy [see *Use in Specific Populations (8.1, 8.3)*].

6 ADVERSE REACTIONS

The following clinically significant adverse reactions are described elsewhere in the labeling:

- Myelosuppression [see *Warnings and Precautions (5.1)*]
- Infection [see *Warnings and Precautions (5.1)*]
- Hypersensitivity [see *Warnings and Precautions (5.2)*]
- Cutaneous Toxicity [see *Warnings and Precautions (5.3)*]
- Hepatic Venous-Occlusive Disease [see *Warnings and Precautions (5.5)*]
- Central Nervous System Toxicity [see *Warnings and Precautions (5.6)*]
- Carcinogenicity [see *Warnings and Precautions (5.7)*]

6.1 Clinical Trials Experience

Because clinical trials are conducted under widely varying conditions, adverse reaction rates observed in the clinical trials of a drug cannot be directly compared to rates in the clinical trials of another drug and may not reflect the rates observed in practice.

Adverse Reactions With the Preparative Regimen for Class 3 Beta-Thalassemia

The safety of TEPADINA was evaluated by retrospective analysis of 76 pediatric patients with class 3 beta-thalassemia who underwent allogeneic hematopoietic progenitor (stem) cell transplantation (HSCT) using busulfan and cyclophosphamide with TEPADINA (n=25) or without TEPADINA (n=51) [see *Clinical Studies (14)*]. Adverse reactions were abstracted retrospectively from the medical records.

Serious adverse events that occurred in the TEPADINA-treated and control cohort were, respectively: gastrointestinal hemorrhage (4% vs 2%), pneumonia (4% vs 0), seizure (4% vs 2%), subarachnoid hemorrhage (4% vs 0) and veno-occlusive disease (4% vs 2%). By 90 days after HSCT, grades 2 to 4 acute graft-versus-host disease was observed in 7 (28%) patients in the TEPADINA cohort and in 13 (26%) patients in the control cohort. By 1-year after transplantation, chronic graft-versus-host disease was observed in 8 (35%) of 23 evaluable patients in the TEPADINA cohort, and 7 (14%) of 49 evaluable patients in the control cohort.

Adverse reactions occurring in at least 5% of patients treated with TEPADINA from start of the preparative regimen through 30 days after transplantation are shown in Table 3.

Table 3: Common Adverse Reactions (>5%) Occurring Through 30 Days After Transplantation In Patients With Class 3 Beta-Thalassemia Using Busulfan And Cyclophosphamide With Or Without TEPADINA in the Preparative Regimen

Adverse Reaction	Preparative Regimen of Busulfan and Cyclophosphamide			
	With TEPADINA N=25 patients (%)		Without TEPADINA N=51 patients (%)	
	Any Grade	Grade 3-5 ¹	Any Grade	Grade 3-5 ¹
Mucositis ²	16 (64%)	4 (16%)	22 (43%)	1 (2%)
Cytomegalovirus Infection	12 (48%)	0	15 (29%)	0
Hemorrhage ³	7 (28%)	2 (8%)	12 (24%)	3 (6%)
Diarrhea	6 (24%)	0	7 (14%)	2 (4%)
Hematuria ⁴	5 (20%)	0	10 (20%)	3 (6%)
Rash ⁵	3 (12%)	0	11 (22%)	0
Intracranial Hemorrhage ⁶	2 (8%)	1 (4%)	0	0
Pseudomonas Infection	2 (8%)	0	0	0

¹Severe, life-threatening or fatal

²Mucositis includes mouth hemorrhage, mucosal inflammation and stomatitis

³Hemorrhage includes all hemorrhage terms

⁴Hematuria includes cystitis hemorrhagic and hematuria

⁵Rash includes dermatitis exfoliative, palmar erythema, rash, rash maculo-papular, rash pruritic and skin toxicity

⁶Hemorrhage Intracranial includes hemorrhage intracranial and subarachnoid hemorrhage

All patients in the TEPADINA-treated and control cohorts developed profound cytopenias, including neutropenia, anemia, thrombocytopenia. Table 4 shows the selected chemistry abnormalities that occurred from start of the preparative regimen through 30 days after transplantation.

Table 4: Selected Laboratory Abnormalities Occurring Through 30 Days After Transplantation In Patients With Class 3 Beta-Thalassemia Using Busulfan And Cyclophosphamide With Or Without TEPADINA in the Preparative Regimen

Adverse Reaction	Preparative Regimen of Busulfan and Cyclophosphamide			
	With TEPADINA N=25 patients (%)		Without TEPADINA N=51 patients (%)	
	Any Grade	Grade 3-4	Any Grade	Grade 3-4
Elevated alanine aminotransferase	22 (88%)	6 (24%)	49 (96%)	14 (27%)
Elevated aspartate aminotransferase	20 (80%)	4 (16%)	45 (88%)	9 (18%)
Elevated total bilirubin	20 (80%)	4 (16%)	39 (77%)	2 (4%)

Adverse Reactions with Treatment of adenocarcinoma of the breast, adenocarcinoma of the ovary, malignant effusions and superficial papillary carcinoma of the urinary bladder

Gastrointestinal: Nausea, vomiting, abdominal pain, anorexia.

General: Fatigue, weakness. Febrile reaction and discharge from a subcutaneous lesion may occur as the result of breakdown of tumor tissue.

Hypersensitivity Reactions: Allergic reactions - rash, urticaria, laryngeal edema, asthma, anaphylactic shock, wheezing.

Local Reactions: Contact dermatitis, pain at the injection site.

Neurologic: Dizziness, headache, blurred vision.

Renal: Dysuria, urinary retention, chemical cystitis or hemorrhagic cystitis.

Reproductive: Amenorrhea, interference with spermatogenesis.

Respiratory: Prolonged apnea has been reported when succinylcholine was administered prior to surgery, following combined use of thiotepa and other anticancer agents. It was theorized that this was caused by decrease of pseudocholinesterase activity caused by the anticancer drugs.

Skin: Dermatitis, alopecia. Skin depigmentation has been reported following topical use.

Special Senses: Conjunctivitis.

6.2 Postmarketing Experience

The following adverse reactions have been identified during post approval use of TEPADINA in preparative regimens prior to allogeneic or autologous hematopoietic progenitor (stem) cell transplantation (HSCT) in adult and pediatric patients. Because these reactions are reported voluntarily from a population of uncertain size, it is not always possible to reliably estimate their frequency or establish a causal relationship to drug exposure.

Blood and lymphatic system disorders: Febrile bone marrow aplasia.

Cardiac disorders: Bradycardia, cardiac failure congestive, cardio-respiratory arrest, pericardial effusion, pericarditis, right ventricular hypertrophy.

Congenital, familial and genetic disorders: Aplasia.

Ear and labyrinth disorders: Deafness.

Eye disorders: Blindness, eyelid ptosis, papilledema, strabismus.

Gastrointestinal disorders: Ascites, dysphagia, enterocolitis, gastritis, palatal disorder.

General disorders and administration site conditions: Device related infection, gait disturbance, malaise, multi-organ failure, pain.

Hepatobiliary disorders: Hepatomegaly.

Immune system disorders: Bone marrow transplant rejection, immunosuppression.

Infections and infestations: Acute sinusitis, bronchopulmonary aspergillosis, candida sepsis, enterococcal infection, Epstein-Barr virus infection, Escherichia sepsis, Fusarium infection, gastroenteritis, infection, lower respiratory tract infection fungal, lower respiratory tract infection viral, parainfluenza virus infection, Pneumonia legionella, relapsing fever, respiratory tract infection, sepsis, septic shock, Staphylococcal bacteremia, Staphylococcal infection, systemic candida, urinary tract infection.

Injury, poisoning and procedural complications: Refractoriness to platelet transfusion, subdural hematoma.

Investigations: Coagulation test abnormal, hemoglobin decreased, Klebsiella test positive, nuclear magnetic resonance imaging brain abnormal, transaminases increased, weight increased.

Metabolism and nutrition disorders: Hyponatremia.

Neoplasms benign, malignant and unspecified (incl. cysts and polyps): Breast cancer metastatic, central nervous system lymphoma, leukemia recurrent, lymphoma, malignant neoplasm progression, metastatic neoplasm, post transplant lymphoproliferative disorder.

Nervous system disorders: Aphasia, brain injury, bulbar palsy, central nervous system lesion, cerebral microangiopathy, cerebral ventricle dilatation, cerebrovascular accident, cognitive disorder, convulsion, coordination abnormal, encephalitis, encephalopathy, hemiplegia, hypotonia, leukoencephalopathy, memory impairment, motor dysfunction, neurotoxicity, quadriparesis, speech disorder, tremor, VIIIth nerve paralysis, white matter lesion.

Psychiatric disorders: Delirium, depression, disorientation, suicidal ideation.

Renal and urinary disorders: Renal failure, nephropathy toxic.

Respiratory, thoracic and mediastinal disorders: Acute respiratory distress, aspiration, dyspnea exertional, interstitial lung disease, lung disorder, pneumonitis, pulmonary arteriopathy, pulmonary sepsis, pulmonary veno-occlusive disease, respiratory distress, respiratory failure, pulmonary hypertension.

Skin and subcutaneous tissue disorders: Stevens-Johnson syndrome and toxic epidermal necrolysis.

Vascular disorders: Capillary leak syndrome.

7 DRUG INTERACTIONS

7.1 Effect of Cytochrome CYP3A Inhibitors and Inducers

In vitro studies suggest that thiotepa is metabolized by CYP3A4 and CYP2B6 to its active metabolite TEPA. Avoid co-administration of strong CYP3A4 inhibitors (e.g., itraconazole, clarithromycin, ritonavir) and strong CYP3A4 inducers (e.g., rifampin, phenytoin) with TEPADINA due to the potential effects on efficacy and toxicity [see *Clinical Pharmacology*]

(12.3)]. Consider alternative medications with no or minimal potential to inhibit or induce CYP3A4. If concomitant use of strong CYP3A4 modulators cannot be avoided, closely monitor for adverse drug reactions.

7.2 Effect of TEPADINA on Cytochrome CYP2B6 Substrates

In vitro studies suggest that thiotepa inhibits CYP2B6. TEPADINA may increase the exposure of drugs that are substrates of CYP2B6 in patients; however, the clinical relevance of this *in vitro* interaction is unknown [see *Clinical Pharmacology* (12.3)].

The administration of thiotepa with cyclophosphamide in patients reduces the conversion of cyclophosphamide to the active metabolite, 4-hydroxycyclophosphamide; the effect appears sequence dependent with a greater reduction in the conversion to 4-hydroxycyclophosphamide when thiotepa is administered 1.5 hours prior to the intravenous administration of cyclophosphamide compared to administration of thiotepa after intravenous cyclophosphamide [see *Clinical Pharmacology* (12.3)]. The reduction in 4-hydroxycyclophosphamide levels may potentially reduce efficacy of cyclophosphamide treatment.

8 USE IN SPECIFIC POPULATIONS

8.1 Pregnancy

Risk Summary

TEPADINA can cause fetal harm when administered to a pregnant woman based on findings from animals and the drug's mechanism of action [see *Clinical Pharmacology* (12.1)]. Limited available data with TEPADINA use in pregnant women are insufficient to inform a drug-associated risk of major birth defects and miscarriage. In animal reproduction studies, administration of thiotepa to pregnant mice and rats during organogenesis produced teratogenic effects (neural tube defects and malformations of the skeletal system of the fetus) at doses approximately 0.125 and 1 times, respectively, the maximum recommended human daily dose on a mg/m² basis. Thiotepa was lethal to rabbit fetuses at approximately 2 times the maximum recommended human therapeutic dose based on body-surface area [see *Data*]. Consider the benefits and risks of TEPADINA for the mother and possible risks to the fetus when prescribing TEPADINA to a pregnant woman.

The estimated background risk of major birth defects and miscarriage for the indicated population is unknown. In the U.S. general population, the estimated background risk of major birth defects and miscarriage in clinically recognized pregnancies is 2-4% and 15-20%, respectively.

Data

Animal Data

Thiotepa given by the IP route in mice at doses ≥ 1 mg/kg (3.2 mg/m²), approximately 8-fold less than the maximum recommended human therapeutic dose based on body-surface area, and in rats at doses ≥ 3 mg/kg (21 mg/m²), approximately equal to the maximum recommended human therapeutic dose based on body-surface area, resulted in various malformations including neural tube defects, omphalocele, renal agenesis, atresia ani, limb and digit defects, cleft palate, micrognathia, other skeletal anomalies in the skull, vertebrae and ribs, and reduced skeletal ossification. Thiotepa was lethal to rabbit fetuses at a dose of 3 mg/kg (41 mg/m²), approximately 2 times the maximum recommended human therapeutic dose based on body-surface area.

8.2 Lactation

Risk Summary

There is no information regarding the presence of thiotepa in human milk, the effects on the breastfed infant, or the effects on milk production.

Because of the potential for serious adverse reactions, including the potential for tumorigenicity shown for thiotepa in

animal studies, advise patients not to breastfeed during TEPADINA treatment.

8.3 Females and Males of Reproductive Potential

TEPADINA can cause fetal harm when administered to a pregnant woman [see *Use in Specific Populations (8.1)*].

Pregnancy testing

Verify the pregnancy status of females of reproductive potential prior to initiating TEPADINA therapy.

Contraception

Females

Advise females of reproductive potential to avoid pregnancy during TEPADINA treatment and for 6 months after the final dose of TEPADINA. Advise females to immediately report pregnancy [see *Use in Specific Populations (8.1)*].

Males

TEPADINA may damage spermatozoa and testicular tissue, resulting in possible genetic abnormalities. Males with female sexual partners of reproductive potential should use effective contraception during TEPADINA treatment and for 1 year after the final dose of TEPADINA [see *Nonclinical Toxicology (13.1)*].

Infertility

Based on nonclinical findings, male and female fertility may be compromised by treatment with TEPADINA. Inform male patients about the possibility of sperm conservation before the start of therapy [see *Nonclinical Toxicology (13.1)*].

8.4 Pediatric Use

The safety and effectiveness of TEPADINA for prevention of graft rejection in pediatric patients undergoing allogeneic HSCT for class 3 beta-thalassemia was established in one prospective study and one retrospective study [see *Clinical Studies (14)*] that included 1 infant (1 month to 1 year), 23 children (2 to 11 years) and 13 adolescents (12 to 16 years) who received TEPADINA as part of their preparative regimen. Safety and effectiveness of TEPADINA in neonates have not been established.

Safety and effectiveness of TEPADINA for treatment of adenocarcinoma of the breast, adenocarcinoma of the ovary, malignant effusions and superficial papillary carcinoma of the urinary bladder in pediatric patients have not been established.

8.5 Geriatric Use

The safety and effectiveness of TEPADINA as a preparative regimen prior to allogeneic hematopoietic progenitor (stem) cell transplantation (HSCT) for patients with class 3 beta-thalassemia have not been established in geriatric patients. Clinical studies of TEPADINA for this indication did not include subjects aged 65 and over.

Clinical studies of TEPADINA for treatment of adenocarcinoma of the breast, adenocarcinoma of the ovary, malignant effusions and superficial papillary carcinoma of the urinary bladder did not include sufficient numbers of subjects aged 65 and over to determine whether elderly subjects respond differently from younger subjects, and other reported clinical experience has not identified differences in responses between the elderly and younger patients. In general, dose selection for an elderly patient should be cautious, usually starting at the low end of the dosing range, reflecting the greater frequency of decreasing hepatic, renal or cardiac function, and of concomitant disease or other drug therapy.

8.6 Renal Impairment

In patients with moderate (creatinine clearance (CL_{Cr}) of 30 mL/min to 59 mL/min) renal impairment, decreased renal excretion may result in increased plasma levels of thiotepa and TEPA [see *Clinical Pharmacology (12.3)*]. This may result in increased toxicity. Monitor patients with moderate to severe (CL_{Cr} < 30 mL/min) renal impairment for signs and symptoms

of toxicity following treatment with TEPADINA for an extended period of time.

8.7 Hepatic Impairment

Thiotepa is extensively metabolized in the liver. Patients with moderate (bilirubin levels greater than 1.5 times to 3 times the upper limit of normal and any AST) hepatic impairment may have increased plasma levels of thiotepa [see *Clinical Pharmacology (12.3)*]. This may result in toxicity. Monitor patients with moderate to severe (bilirubin levels greater than 3 times upper limit of normal and any AST) hepatic impairment for signs and symptoms of toxicity following treatment with TEPADINA for an extended period of time.

10 OVERDOSE

There is no experience with overdoses of thiotepa. The most important adverse reactions expected in case of overdose are myeloablation and pancytopenia [see *Nonclinical Toxicology (13)*]. There is no known antidote for thiotepa. Monitor the hematological status closely and provide vigorous supportive measures as medically indicated.

11 DESCRIPTION

TEPADINA (thiotepa) is an alkylating agent. TEPADINA (thiotepa) for injection is supplied as a non-pyrogenic, sterile lyophilized white powder for intravenous, intracavitary, or intravesical use after reconstitution and dilution.

TEPADINA is available

- In a single-dose vial containing 15 mg thiotepa. After reconstitution with 1.5 mL of Sterile Water for Injection, each mL contains 10 mg thiotepa;
- In a single-dose vial containing 100 mg thiotepa. After reconstitution with 10 mL of Sterile Water for Injection, each mL contains 10 mg thiotepa;
- In a single-dose multichamber flexible bag containing 200 mg thiotepa and 200 mL 0.9% Sodium Chloride Injection;

Thiotepa is a synthetic product with antitumor activity. The chemical name for thiotepa is Tris(1-aziridiny)phosphine sulfide. Thiotepa has the following structural formula:

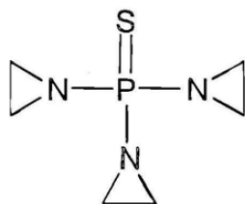

Thiotepa has the molecular formula $C_6H_{12}N_3PS$, and a molecular weight of 189.23, and it appears as fine, white crystalline flakes, with a melting range of 52°C to 57°C . It is soluble in water and organic solvents. When reconstituted with sterile water for injection, the resulting solution has a pH of approximately 5.5 to 7.5. Thiotepa is unstable in acid medium.

12 CLINICAL PHARMACOLOGY

12.1 Mechanism of Action

Thiotepa is a cytotoxic agent of the polyfunctional type, related chemically and pharmacologically to the nitrogen mustard. The radiomimetic action of thiotepa is believed to occur through the release of ethyleneimine radicals which, like irradiation,

disrupt the bonds of DNA. One of the principle bond disruptions is initiated by alkylation of guanine at the N-7 position, which severs the linkage between the purine base and the sugar and liberates alkylated guanines.

12.2 Pharmacodynamics

The exposure-response relationship for efficacy and safety has not been characterized.

12.3 Pharmacokinetics

Absorption

Thiotepa reached maximal concentrations close to the end infusion following an intravenous infusion.

Distribution

The binding of thiotepa to plasma proteins is approximately 10% to 20%. The mean volume of distribution (% coefficient of variation) of thiotepa was 30 L/m² (44%) or 1.2 L/kg (47%) following a single intravenous infusion of TEPADINA at a dose of 5 mg/kg over 3 hours in pediatric population. In adults administered intravenous thiotepa between 20 mg to 250 mg/m² as an intravenous bolus or infusion up to 4 hours, the mean volume of distribution of thiotepa ranged from 1.0 L/kg (30%) to 1.9 L/kg (17%).

Elimination

Following a single intravenous infusion over 3 hours of TEPADINA at a dose of 5 mg/kg in pediatric population, the estimated mean (% coefficient of variation) clearance of thiotepa was 0.58 L/hr/kg (60%) or 13.8 L/hr/m² (52%). The mean terminal elimination half-life was 1.7 hours (64%) for thiotepa and 4 hours (29%) for its major active metabolite, N,N',N"-triethylenephosphoramidate (TEPA) in pediatric population. In adults administered intravenous thiotepa between 20 mg to 250 mg/m² as an intravenous bolus or infusion up to 4 hours, the mean thiotepa clearance ranged from 14.6 L/hr/m² (23%) to 27.9 L/hr/m² (69%). In adult population, the mean terminal elimination half-life ranged from 1.4 hours (7%) to 3.7 hours (14%) for thiotepa and from 4.9 hours to 17.6 hours (20%) for TEPA.

Metabolism

Thiotepa undergoes hepatic metabolism. *In vitro* data suggests that CYP3A4 and CYP2B6 may be responsible for the metabolism of thiotepa to TEPA, a major active metabolite.

Excretion

In adult and pediatric patients, urinary excretion of thiotepa accounted for less than 2% of the dose and TEPA accounted for 11% or less of the dose.

Specific Populations

Hepatic Impairment

The clearance of thiotepa following a single TEPADINA dose of 5 mg/kg in pediatric population with mild hepatic impairment was similar to the clearance observed in patients with normal liver function administered thiotepa. The exposure (as measured by area under the curve (AUC)) of thiotepa increased by 1.6-fold and 1.8-fold following administration of multiple thiotepa doses of 7 mg/kg administered every 2 days with cyclophosphamide in two adult patients who had liver metastases with moderate hepatic impairment compared to the exposure observed in one patient with normal hepatic function. The effect of severe hepatic impairment on thiotepa exposure is unknown.

Renal Impairment

The exposure (as measured by AUC) of thiotepa increased by 1.4-fold and TEPA increased by 2.6-fold following administration of multiple doses of 120 mg/m²/day in one patient with moderate renal impairment (CL_{cr} = 38 mL/min)

administered cyclophosphamide plus thiotepa plus carboplatin, compared to exposure of thiotepa in patients with normal renal function. The effects of severe renal impairment or end-stage renal disease on thiotepa exposure are unknown.

Drug Interactions

The clinical relevance of *in vitro* inhibition of the cytochrome P450 enzymes described below is unknown, but it cannot be excluded that the systemic exposure of thiotepa or medicinal products that are substrates for these enzymes may be affected with concomitant administration with TEPADINA.

Effect of Cytochrome P450 Modulators on Thiotepa

In vitro data demonstrates that CYP3A4 and CYP2B6 inhibitors decrease the metabolism of thiotepa [see *Drug Interactions (7.1)*].

Effect of Thiotepa on Cytochrome P450 2B6

In vitro data demonstrates that thiotepa inhibits CYP2B6.

Effect of Thiotepa on Cyclophosphamide

The administration of thiotepa 1.5 hours prior to intravenous cyclophosphamide in patients administered cyclophosphamide plus thiotepa plus carboplatin decreased the AUC of 4-hydroxycyclophosphamide by 26% and maximal concentrations of 4-hydroxycyclophosphamide by 62%, compared to administration of cyclophosphamide prior to thiotepa.

13 NONCLINICAL TOXICOLOGY

13.1 Carcinogenesis, Mutagenesis, Impairment of Fertility

In mice, repeated intraperitoneal (IP) administration of thiotepa (1.15 or 2.3 mg/kg three times per week for 52 or 43 weeks, respectively) produced a significant increase in the combined incidence of squamous-cell carcinomas of the skin, preputial gland, and ear canal, and combined incidence of lymphoma and lymphocytic leukemia. In other studies in mice, repeated IP administration of thiotepa (4 or 8 mg/kg three times per week for 4 weeks followed by a 20 week observation period or 1.8 mg/kg three times per week for 4 weeks followed by a 35 week observation period) resulted in an increased incidence of lung tumors. In rats, repeated IP administration of thiotepa (0.7 or 1.4 mg/kg three times per week for 52 or 34 weeks, respectively) produced significant increases in the incidence of squamous-cell carcinomas of the skin or ear canal, combined hematopoietic neoplasms, and uterine adenocarcinomas. Thiotepa given intravenously (IV) to rats (1 mg/kg once per week for 52 weeks) produced an increased incidence of malignant tumors (abdominal cavity sarcoma, lymphosarcoma myelosis, seminoma, fibrosarcoma, salivary gland hemangioendothelioma, mammary sarcoma, pheochromocytoma) and benign tumors.

The lowest reported carcinogenic dose in mice (1.15 mg/kg, 3.68 mg/m²) is approximately 7-fold less than the maximum recommended human therapeutic dose based on body-surface area. The lowest reported carcinogenic dose in rats (0.7 mg/kg, 4.9 mg/m²) is approximately 6-fold less than the maximum recommended human therapeutic dose based on body-surface area.

Thiotepa was mutagenic in *in vitro* assays in *Salmonella typhimurium*, *E coli*, Chinese hamster lung and human lymphocytes. Chromosomal aberrations and sister chromatid exchanges were observed *in vitro* with thiotepa in bean root tips, human lymphocytes, Chinese hamster lung, and monkey lymphocytes.

Mutations were observed with oral thiotepa in mouse at doses > 2.5 mg/kg (8 mg/m²). The mouse micronucleus test was positive with intraperitoneal administration of > 1 mg/kg (3.2 mg/m²). Other positive *in vivo* chromosomal aberration or mutation assays included *Drosophila melanogaster*, Chinese hamster marrow, murine marrow, monkey lymphocyte, and

murine germ cell.

Thiotepa impaired fertility in male mice at oral or intraperitoneal doses ≥ 0.7 mg/kg (2.24 mg/m²), approximately 12-fold less than the maximum recommended human therapeutic dose based on body-surface area. Thiotepa (0.5 mg) inhibited implantation in female rats when instilled into the uterine cavity. Thiotepa interfered with spermatogenesis in mice at IP doses ≥ 0.5 mg/kg (1.6 mg/m²), approximately 17-fold less than the maximum recommended human therapeutic dose based on body-surface area. Thiotepa interfered with spermatogenesis in hamsters at an IP dose of 1 mg/kg (4.1 mg/m²), approximately 7-fold less than the maximum recommended human therapeutic dose based on body-surface area.

14 CLINICAL STUDIES

TEPADINA was evaluated in a retrospective study of pediatric patients with class 3 beta-thalassemia who underwent allogeneic hematopoietic progenitor (stem) cell transplantation (HSCT) from a human leukocyte antigen (HLA)-identical sibling donor. Twenty-five patients (10 male and 15 female) of median age 10 years (range, 5-16 years) were treated with intravenous busulfan at weight-based dosing from Day -10 to Day -7 pretransplant [*see Table 1*], intravenous TEPADINA 5 mg/kg twice on Day -6, intravenous cyclophosphamide 40 mg/kg/day on Day -5 to Day -2, and marrow infusion on Day 0. All patients had also received precytoreduction with hydroxyurea, azathioprine and fludarabine prior to start of the preparative regimen.

Efficacy was based on the incidence of graft rejection (primary or late rejection). The incidence of graft rejection in these 25 patients using TEPADINA was 0% (95% CI: [0, 0.12]). Of the 51 patients who received the same preparative regimen, historically, without TEPADINA, the incidence of graft rejection reported was 25.5% (95% CI: [0.13, 0.37]).

15 REFERENCES

1. OSHA Hazardous Drugs. OSHA, <http://www.osha.gov/SLTC/hazardousdrugs/index.html>.

16 HOW SUPPLIED/STORAGE AND HANDLING

How Supplied

TEPADINA (thiotepa) for injection is a lyophilized white powder supplied in a carton containing one single-dose Type I clear glass vial with a rubber stopper (not made with natural rubber latex) or in an aluminum overwrap containing one single-dose multichamber flexible bag as:

TEPADINA 15 mg

One vial contains 15 mg thiotepa (NDC 70121-1630-1).

TEPADINA 100 mg

One vial contains 100 mg thiotepa (NDC 70121-1631-1).

TEPADINA 200 mg

One multichamber flexible bag contains 200 mg thiotepa and 200 mL 0.9% Sodium Chloride Injection (NDC 70121-2749-1).

Storage and Handling

TEPADINA multichamber flexible bag and vials must be stored and transported refrigerated at 2°C to 8°C (36°F to 46°F). Do not freeze. Keep the bag in the aluminum overwrap in order to protect it from activation.

TEPADINA is a hazardous drug. Follow applicable special handling and disposal procedures.¹

17 PATIENT COUNSELING INFORMATION

Hypersensitivity

Counsel patients on the signs and symptoms of hypersensitivity and to seek immediate emergency assistance if they develop any of these signs and symptoms [see *Warnings and Precautions (5.2)*].

Myelosuppression

Inform patients of the possibility of developing low blood cell counts and the need for hematopoietic progenitor cell infusion. Instruct patients to immediately report to their healthcare provider if bleeding or fever occurs [see *Warnings and Precautions (5.1)*].

Females and Males of Reproductive Potential

TEPADINA can cause fetal harm. Advise females receiving TEPADINA to avoid pregnancy during TEPADINA treatment and for 6 months after the last dose of TEPADINA [see *Warnings and Precautions (5.8)*].

Advise males with female sexual partners of reproductive potential to use effective contraception during TEPADINA treatment and for 1 year after the last dose of TEPADINA [see *Use in Specific Populations (8.3)*].

Advise females to report pregnancy immediately [see *Warnings and Precautions (5.8)*].

Advise patients that TEPADINA can produce infertility. Inform male patients about the possibility of sperm conservation before the start of therapy [see *Use in Specific Populations (8.3)*].

Lactation

Advise patients to avoid breastfeeding while receiving TEPADINA [see *Use in Specific Populations (8.2)*].

Secondary malignancies

Inform patients that TEPADINA can increase the risk of secondary malignancy [see *Warnings and Precautions (5.7)*].

Distributed by:

Amneal Pharmaceuticals LLC
Bridgewater, NJ 08807

for
ADIENNE SA
Switzerland

U.S. Pat. No. 9,931,458
U.S. Pat. No. 10,369,077

U.S. Pat. No. 10,383,792

U.S. Pat. No 10,507,165

U.S. Pat. No. 11,497,683

U.S. Pat. No. 11,744,776

(Logo ADIENNE)

←
→

TEPADINA® (thiotepa) for Injection Rx only

200 mg / bag

NDC 70121-2749-1

For intravenous infusion after activation

One multichamber flexible bag contains 200 mg thiotepa and 200 mL 0.9% Sodium Chloride Injection, USP. **Warning: Hazardous Drug**

Activate seal and gently mix powder and solution.

See prescribing information for instructions for use.

Keep out of the sight and reach of children.

Recommended Dosage: See prescribing information.



N 70121 27491 9

Store and transport refrigerated between 2°C to 8°C (36°F to 46°F). Do not freeze. Keep the bag in the aluminum overwrap in order to protect from activation.

Single-Dose container. Discard Unused Portion.
 After activation, the resultant concentration is 200 mg/200 mL (1 mg/mL).
 Store reconstituted solution refrigerated at 2°C to 8°C (36°F to 46°F) and discard after 168 hours or at room temperature 20°C to 25°C (68°F to 77°F) and discard after 56 hours. Discard after ___/___/___ [Time]

Distributed by Amneal Pharmaceuticals LLC
 Bridgewater, NJ 08807
 for ADIENNE SA, Switzerland



Lot XXXXXXX
 EXP YYYY/MM/DD

←
→

200 mg / bag
(thiotepa) for Injection
TEPADINA[®]
NDC 70121-2749-1 Rx only

NDC 70121-2749-1 Rx only

TEPADINA[®]
(thiotepa) for Injection
200 mg / bag

For intravenous infusion
after activation

One multichamber flexible bag contains 200 mg thiotepa and 200 mL 0.9% Sodium Chloride Injection, USP.

Warning: Hazardous Drug

Store and transport refrigerated between 2°C to 8°C (36°F to 46°F).
Do not freeze.
Keep the bag in the aluminum overwrap in order to protect from activation.
Keep out of the sight and reach of children.
Recommended Dosage: See prescribing information.
Single-Dose container. Discard Unused Portion.
After activation, the resultant concentration is 200 mg/200 mL (1 mg/mL).
Store reconstituted solution refrigerated at 2°C to 8°C (36°F to 46°F) and discard after 168 hours or at room temperature 20°C to 25°C (68°F to 77°F) and discard after 56 hours.
Discard after ___/___/___ [time ___]

ADIENNE
PHARMA & BIOTECH

NDC 70121-2749-1 Rx only

TEPADINA[®]
(thiotepa) for Injection
200 mg / bag

NDC 70121-2749-1

TEPADINA[®]
(thiotepa) for Injection
200 mg / bag

Rx only

PC: 00000000000000
SN: XXXXXXXXXXXXXXXX
Lot: XXXXXX
Exp: YY/MM/DD



00000000

NDC 70121-2749-1

TEPADINA[®]
(thiotepa) for Injection
200 mg / bag

Rx only

NDC 70121-2749-1 Rx only

TEPADINA[®]
(thiotepa) for Injection
200 mg / bag

For intravenous infusion
after activation

Single-Dose container
Discard Unused Portion
Sterile

Warning: Hazardous Drug



N 3 70121 27491 9

U.S. Patent No. 9931458, 10369077, 10383792,
10507165, 11497683 and 11744776

Distributed by Amneal Pharmaceuticals LLC
Bridgewater, NJ 08807
for ADIENNE SA, Switzerland

ADIENNE
PHARMA & BIOTECH

90 mm

TEPADINA® (thiotepa) for Injection Rx only

200 mg / bag NDC 70121-2749-1

For intravenous infusion after activation

One multichamber flexible bag contains 200 mg thiotepa and 200 mL 0.9% Sodium Chloride Injection, USP. **Warning: Hazardous Drug**

Activate seal and gently mix powder and solution.

See prescribing information for instructions for use.
 Keep out of the sight and reach of children.
 Recommended Dosage: See prescribing information.



N 70121 27491 9

**Store and transport refrigerated between 2°C to 8°C (36°F to 46°F).
 Do not freeze. Keep the bag in the aluminum overwrap in order to protect from activation.**

Single-Dose container. Discard Unused Portion.
 After activation, the resultant concentration is 200 mg/200 mL (1 mg/mL).
 Store reconstituted solution refrigerated at 2°C to 8°C (36°F to 46°F) and discard after 168 hours or at room temperature 20°C to 25°C (68°F to 77°F) and discard after 56 hours. Discard after ___/___/___ [Time]

Distributed by Amneal Pharmaceuticals LLC Lot XXXXXXX
 Bridgewater, NJ 08807 EXP YYYY/MM/DD
 for ADIENNE SA, Switzerland



70 mm

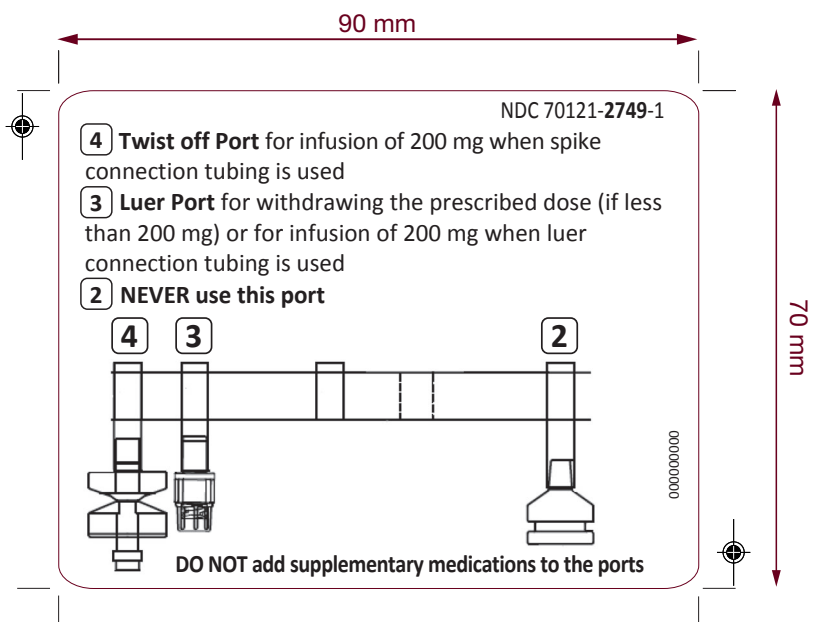

This is a representation of an electronic record that was signed electronically. Following this are manifestations of any and all electronic signatures for this electronic record.

/s/

KELLY J NORSWORTHY
04/10/2025 11:56:34 AM